

1. Apollo 11 stones. Namibia.
c. 25,500–25,300 B.C.E. Charcoal
on stone.



Apollo 11 stones
© Human Origins Program, Smithsonian Institution

2. Great Hall of the Bulls. Lascaux, France.
Paleolithic Europe. 15,000–13,000 B.C.E.
Rock painting.



Great Hall of the Bulls
© The Bridgeman Art Library

3. Camelid sacrum in the shape of a canine. Tequixquiac, central Mexico.
14,000–7000 B.C.E. Bone.



Camelid sacrum
Photo © Jorge Pérez de Lara

4. Running horned woman. Tassili n'Ajjer, Algeria. 6000–4000 B.C.E.
Pigment on rock.



Running horned woman
© The Granger Collection, New York

5. Beaker with ibex motifs.
Susa, Iran. 4200–3500 B.C.E.
Painted terra cotta.



Beaker with ibex motifs
© RMN-Grand Palais/Art Resource, NY

6. Anthropomorphic stele. Arabian Peninsula. Fourth millennium B.C.E.
Sandstone.



Anthropomorphic stele
© Album/Art Resource, NY

7. Jade *cong*. Liangzhu, China.
3300–2200 B.C.E. Carved jade.



Jade *cong*
© Asian Art & Archaeology, Inc./Corbis

8. **Stonehenge.** Wiltshire, UK. Neolithic Europe. c. 2500–1600 B.C.E. Sandstone. (2 images)



Stonehenge

© Last Refuge/Robert Harding World Imagery/Corbis



Stonehenge

© Luca da Ros/SOPA/Corbis

9. **The Ambum Stone.** Ambum Valley, Enga Province, Papua New Guinea. c. 1500 B.C.E. Greywacke.



The Ambum Stone

© National Gallery of Australia, Canberra

10. Tlatilco female figurine. Central Mexico, site of Tlatilco. 1200–900 B.C.E. Ceramic.



Tlatilco female figurine

© Princeton University Art Museum/Art Resource, NY

11. Terra cotta fragment. Lapita. Solomon Islands, Reef Islands. 1000 B.C.E. Terra cotta (incised).



Terra cotta fragment

Courtesy of the Anthropology Photographic Archive, Department of Anthropology, The University of Auckland

12. White Temple and its ziggurat. Uruk (modern Warka, Iraq). Sumerian. c. 3500–3000 B.C.E. Mud brick. (2 images)

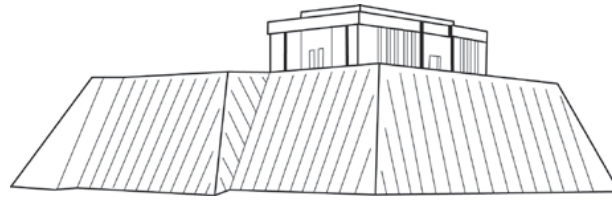

White Temple and ziggurat (reconstruction drawing)

White Temple

© Richard Ashworth/Robert Harding World Imagery

13. Palette of King Narmer. Predynastic Egypt. c. 3000–2920 B.C.E. Greywacke. (2 images)



Palette of King Narmer, back

© Werner Forman/Art Resource, NY



Palette of King Narmer, front

© Werner Forman/Art Resource, NY

14. Statues of votive figures, from the Square Temple at Eshnunna (modern Tell Asmar, Iraq). Sumerian. c. 2700 B.C.E. Gypsum inlaid with shell and black limestone.



Statues of votive figures

© Erich Lessing/Art Resource, NY

15. Seated scribe. Saqqara, Egypt. Old Kingdom, Fourth Dynasty. c. 2620–2500 B.C.E. Painted limestone.

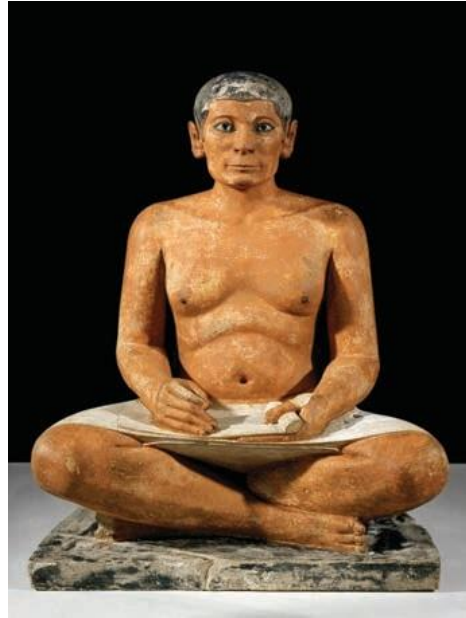

Seated scribe

© Erich Lessing/Art Resource, NY

16. Standard of Ur from the Royal Tombs at Ur (modern Tell el-Muqayyar, Iraq). Sumerian. c. 2600–2400 B.C.E. Wood inlaid with shell, lapis lazuli, and red limestone. (2 images)



Standard of Ur, War

© Eileen Tweedy/The Art Archive at Art Resource, NY

17. Great Pyramids (Menkaura, Khafre, Khufu) and Great Sphinx. Giza, Egypt. Old Kingdom, Fourth Dynasty. c. 2550–2490 B.C.E. Cut limestone. (2 images)



Great Pyramids with Sphinx

© Roger Wood/Corbis

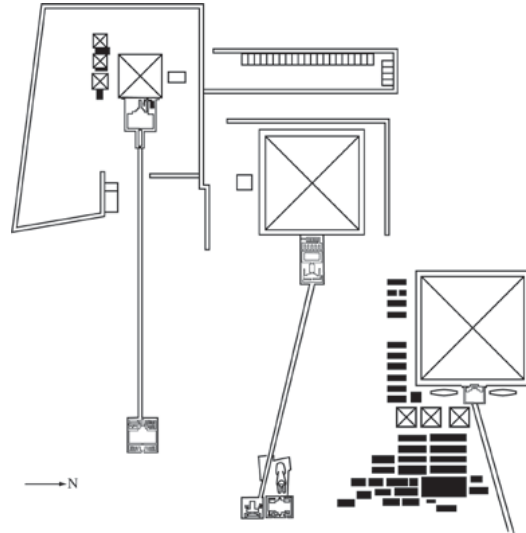

Great Pyramids plan

18. King Menkaura and queen. Old Kingdom, Fourth Dynasty. c. 2490–2472 B.C.E. Greywacke.



King Menkaura and queen

Photograph © 2013 Museum of Fine Arts, Boston

19. The Code of Hammurabi. Babylon (modern Iran). Susian. c. 1792–1750 B.C.E. Basalt.



The Code of Hammurabi

© The Gallery Collection/Corbis

20. Temple of Amun-Re and Hypostyle Hall. Karnak, near Luxor, Egypt. New Kingdom, 18th and 19th Dynasties. Temple: c. 1550 B.C.E.; hall: c. 1250 B.C.E. Cut sandstone and mud brick. (3 images)

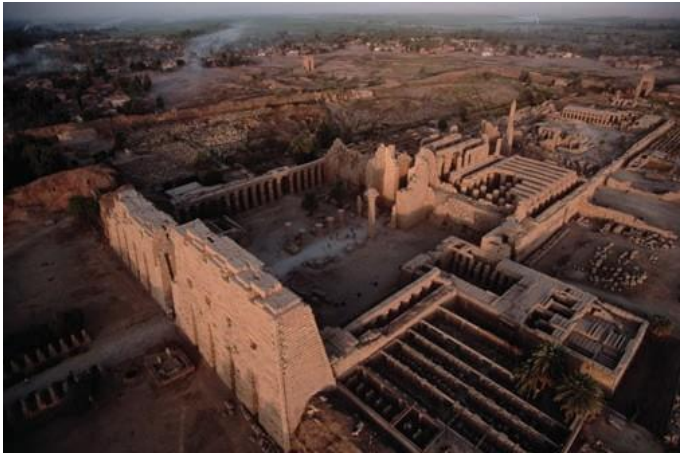

Temple of Amun-Re
© Yann Arthus-Bertrand/Corbis



Hypostyle Hall
© Jochem D. Wijnands/Getty Images

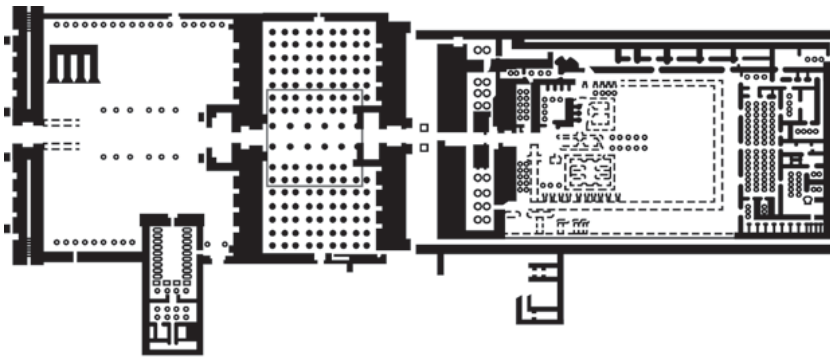

Temple of Amun-Re plan
0 60 m

21. Mortuary temple of Hatshepsut. Near Luxor, Egypt. New Kingdom, 18th Dynasty. c. 1473–1458 B.C.E. Sandstone, partially carved into a rock cliff, and red granite. (2 images)



Mortuary temple of Hatshepsut
© Erich Lessing/Art Resource, NY

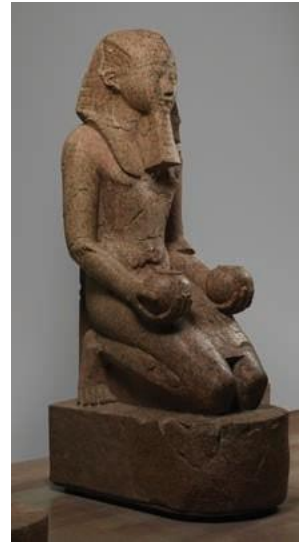

Kneeling statue of Hatshepsut
Image © The Metropolitan Museum of Art/
Image source © Art Resource, NY

22. Akhenaton, Nefertiti, and three daughters. New Kingdom (Amarna), 18th Dynasty. c. 1353–1335 B.C.E. Limestone.



Akhenaton, Nefertiti, and three daughters
© bpk, Berlin/Staatliche Museen/Art Resource, NY

23. Tutankhamun's tomb, innermost coffin. New Kingdom, 18th Dynasty. c. 1323 B.C.E. Gold with inlay of enamel and semiprecious stones.



Tutankhamun's innermost coffin
© Sandra Vannini/Corbis

24. Last judgment of Hu-Nefer, from his tomb (page from the *Book of the Dead*). New Kingdom, 19th Dynasty. c. 1275 B.C.E. Painted papyrus scroll.

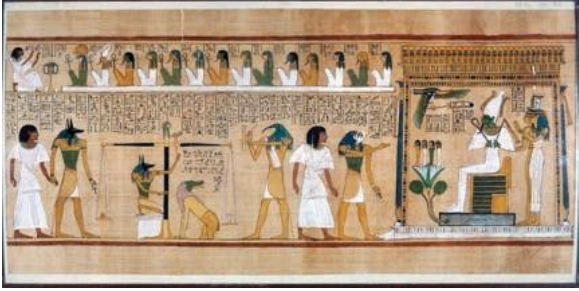

Last judgment of Hu-Nefer

© The Trustees of the British Museum/Art Resource, NY

25. Lamassu from the citadel of Sargon II, Dur Sharrukin (modern Khorsabad, Iraq). Neo-Assyrian. c. 720–705 B.C.E. Alabaster.



Lamassu

© Album/Art Resource, NY

26. Athenian agora. Archaic through Hellenistic Greek. 600 B.C.E.–150 C.E. Plan.

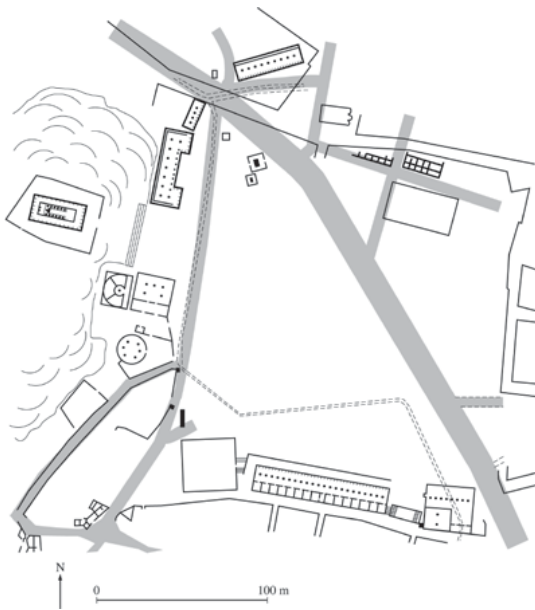

Athenian agora site plan

27. Anavysos Kouros. Archaic Greek. c. 530 B.C.E. Marble with remnants of paint.



Anavysos Kouros

© Scala/Art Resource, NY

28. Peplos Kore from the Acropolis.
Archaic Greek. c. 530 B.C.E. Marble,
painted details.



Peplos Kore

© Gianni Dagli Orti/The Art Archive at Art Resource, NY

29. Sarcophagus of the Spouses.
Etruscan. c. 520 B.C.E. Terra cotta.



Sarcophagus of the Spouses

© Gianni Dagli Orti/The Art Archive at Art Resource, NY

30. Audience Hall (*apadana*) of Darius and Xerxes. Persepolis, Iran. Persian. c. 520–465 B.C.E.
Limestone. (2 images)



Apadana

© Imagestate Media Partners Limited - Impact Photos/Alamy



Apadana stairway

© Gérard Degeorge/Corbis

31. Temple of Minerva (Veii, near Rome, Italy) and sculpture of Apollo. Master sculptor Vulca. c. 510–500 B.C.E. Original temple of wood, mud brick, or tufa (volcanic rock); terra cotta sculpture. (3 images)

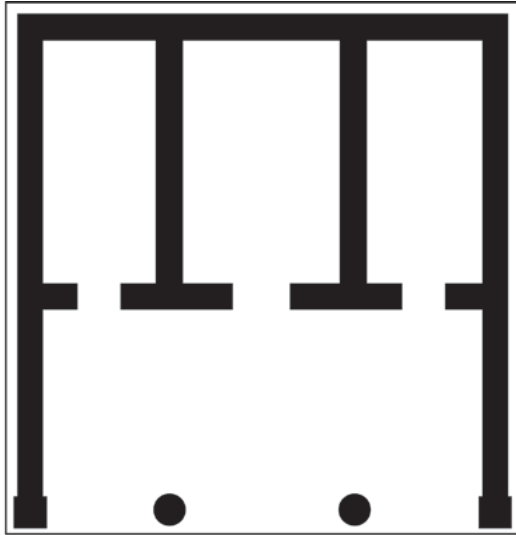

0 10 m
Temple of Minerva plan



0 10 m
Temple of Minerva elevation



Apollo

© Scala/Ministero per i Beni e le Attività culturali/Art Resource, NY

32. Tomb of the Triclinium. Tarquinia, Italy.
Etruscan. c. 480–470 B.C.E. Tufa and fresco.

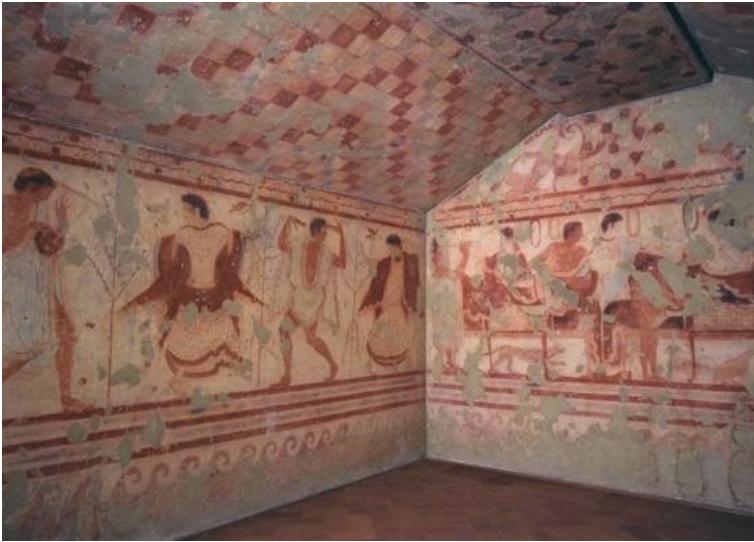

Tomb of the Triclinium

© Nimatallah/Art Resource, NY

33. Niobides Krater. Anonymous vase painter of Classical Greece known as the Niobid Painter. c. 460–450 B.C.E. Clay, red-figure technique (white highlights). (2 images)



Niobides Krater

© RMN-Grand Palais/Art Resource, NY



Niobides Krater

© RMN-Grand Palais/Art Resource, NY

34. *Doryphoros (Spear Bearer).*
Polykleitos. Original 450–440 B.C.E.
Roman copy (marble) of Greek original
(bronze).



Doryphoros

© Museo Archeologico Nazionale, Naples, Italy/
The Bridgeman Art Library

35. Acropolis. Athens, Greece. Iktinos and Kallikrates. c. 447–410 B.C.E. Marble. (6 images)

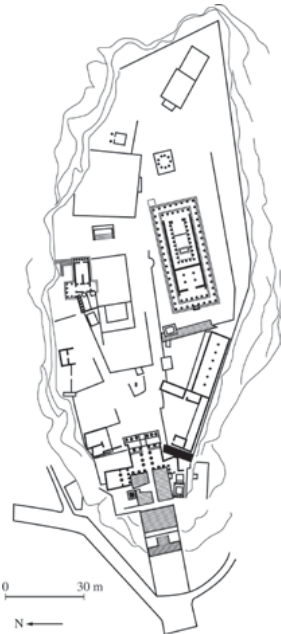

Acropolis plan



Parthenon

© SGM/The Bridgeman Art Library

Acropolis, *continued*



Helios, horses, and Dionysus (Heracles?)

© The Trustees of the British Museum



Temple of Athena Nike

© Gianni Dagli Orti/The Art Archive at Art Resource, NY



Victory adjusting her sandal

© Nimatallah/Art Resource, NY



Plaque of the Ergastines

© RMN-Grand Palais/Art Resource, NY

36. Grave stele of Hegeso. Attributed to Kallimachos. c. 410 B.C.E. Marble and paint.



Grave stele of Hegeso

© Nimatallah/Art Resource, NY

37. *Winged Victory of Samothrace.* Hellenistic Greek. c. 190 B.C.E. Marble.



Winged Victory of Samothrace

© RMN-Grand Palais/Art Resource, NY

38. Great Altar of Zeus and Athena at Pergamon. Asia Minor (present-day Turkey). Hellenistic Greek. c. 175 B.C.E. Marble (architecture and sculpture). (3 images)



Great Altar of Zeus and Athena

© bpk, Berlin/Antikensammlung, Staatliche Museen/Photo © Juergen Liepe/Art Resource, NY



Athena

© Erich Lessing/Art Resource, NY

Great Altar of Zeus and Athena at Pergamon, *continued*

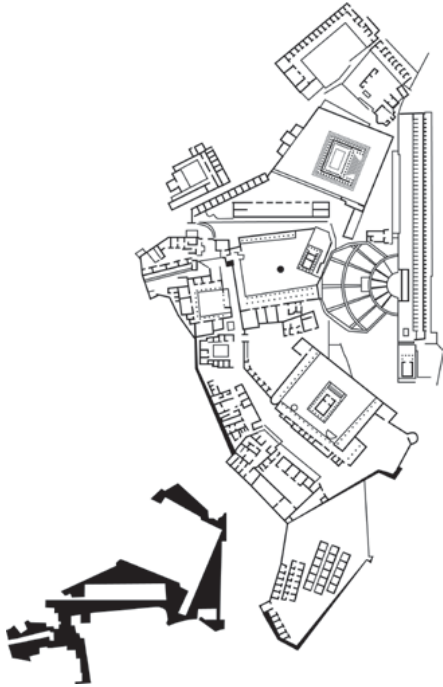

Great Altar of Zeus and Athena plan

39. House of the Vettii. Pompeii, Italy. Imperial Roman. c. second century B.C.E.; rebuilt c. 62–79 C.E. Cut stone and fresco. (3 images)

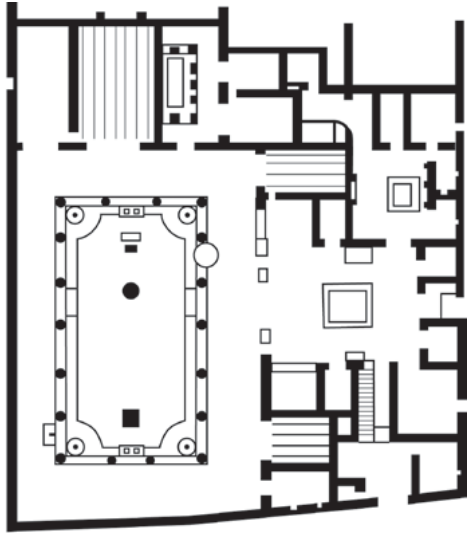

0 10 m

House of the Vettii plan



House of the Vettii, *continued*



Frescoes

© Scala/Art Resource, NY

40. **Alexander Mosaic** from the House of Faun, Pompeii. Republican Roman. c. 100 B.C.E. Mosaic.



Alexander Mosaic

© Araldo de Luca/Corbis

41. **Seated boxer.** Hellenistic Greek. c. 100 B.C.E. Bronze.



Seated boxer

© Vanni Archive/Art Resource, NY

42. **Head of a Roman patrician.** Republican Roman. c. 75–50 B.C.E. Marble.

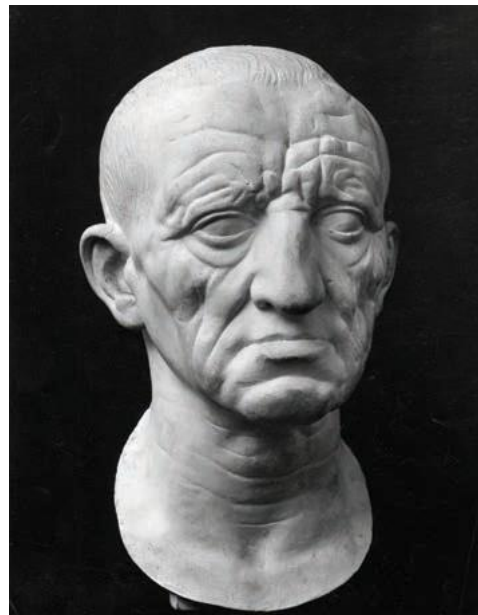

Head of a Roman patrician

© Alinari/Art Resource, NY

43. Augustus of Prima Porta. Imperial Roman. Early first century C.E. Marble.



Augustus of Prima Porta

© Erin Babnik/Alamy

44. Colosseum (Flavian Amphitheater). Rome, Italy. Imperial Roman. 70–80 C.E. Stone and concrete. (2 images)



Colosseum

© Patrick Durand/Sygma/Corbis



Colosseum

© Scala/Ministero per i Beni e le Attività culturali/Art Resource, NY

45. **Forum of Trajan.** Rome, Italy. Apollodorus of Damascus. Forum and markets: 106–112 C.E.; column completed 113 C.E. Brick and concrete (architecture); marble (column). (4 images)



Basilica Ulpia (reconstruction drawing)

© Gilbert Gorski and James Packer



Trajan markets

© Franz-Marc Frei/Corbis



Column of Trajan

© Vittoriano Rastelli/Corbis

46. Pantheon. Imperial Roman. 118–125 C.E. Concrete with stone facing. (2 images)



Pantheon

© Scala/Art Resource, NY



Pantheon

© Vanni Archive/Art Resource, NY

47. Ludovisi Battle Sarcophagus. Late Imperial Roman. c. 250 C.E. Marble.



Ludovisi Battle Sarcophagus

© Gianni Dagli Orti/The Art Archive at Art Resource, NY

48. Catacomb of Priscilla. Rome, Italy. Late Antique Europe. c. 200–400 C.E.
Excavated tufa and fresco. (3 images)



Greek Chapel

© Scala/Art Resource, NY

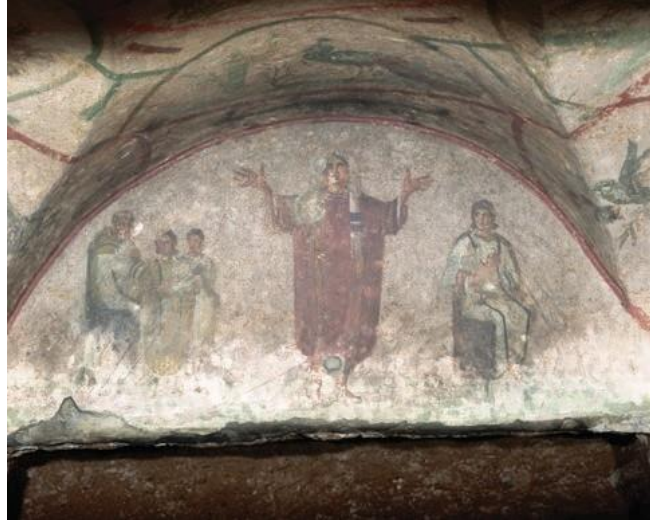

Orant fresco

© Araldo de Luca/Corbis



Good Shepherd fresco

© Scala/Art Resource, NY

49. **Santa Sabina.** Rome, Italy. Late Antique Europe. c. 422–432 C.E. Brick and stone, wooden roof. (3 images)



Santa Sabina
© Scala/Art Resource, NY

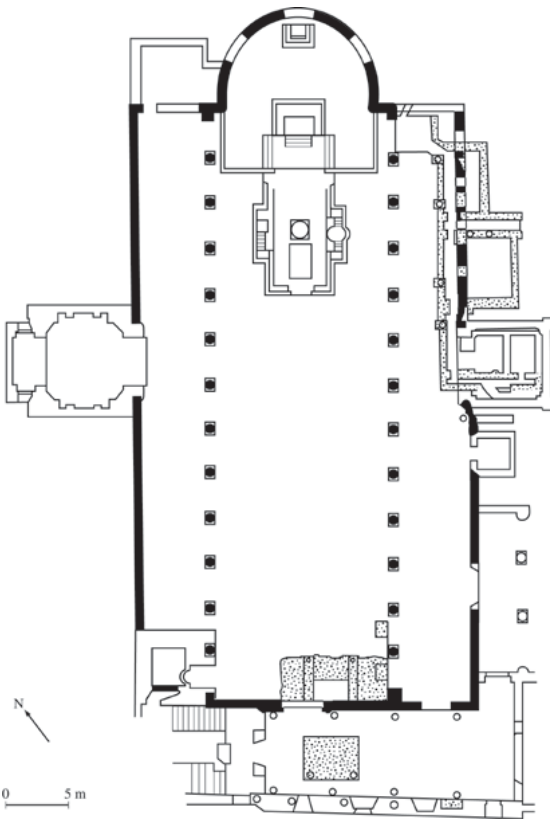

Santa Sabina plan

50. Rebecca and Eliezer at the Well and Jacob Wresting the Angel, from the **Vienna Genesis**. Early Byzantine Europe. Early sixth century C.E. Illuminated manuscript (tempera, gold, and silver on purple vellum). (2 images)



Rebecca and Eliezer at the Well
© Österreichische Nationalbibliothek, Gr. 31, fol. 7r



Jacob Wrestling the Angel
© Österreichische Nationalbibliothek, Gr. 31, fol. 12r

51. **San Vitale**. Ravenna, Italy. Early Byzantine Europe. c. 526–547 C.E. Brick, marble, and stone veneer; mosaic. (5 images)



San Vitale
© Gérard Degeorge/The Bridgeman Art Library

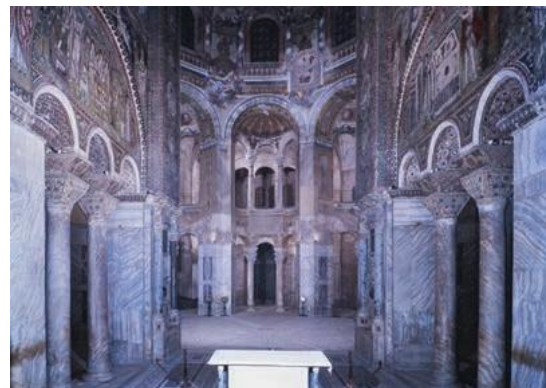

San Vitale
© Canali Photobank, Milan, Italy

San Vitale, *continued*



Theodora panel

© Giraudon/The Bridgeman Art Library

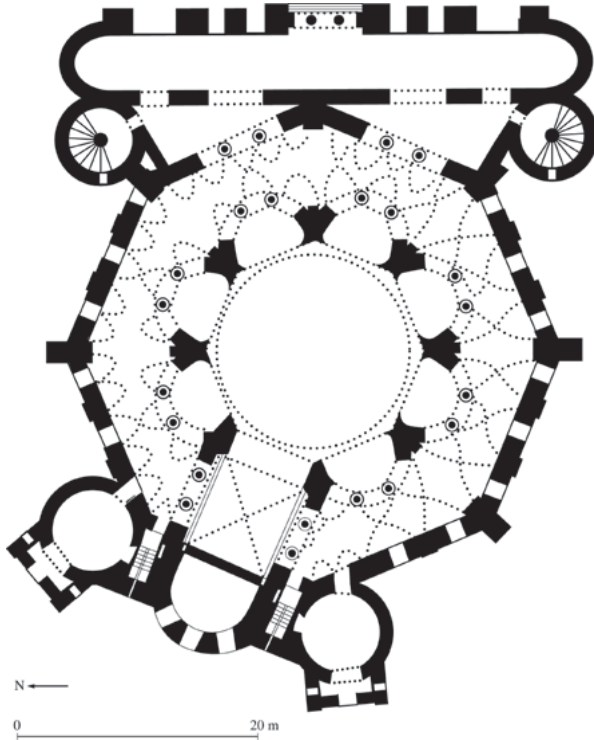

San Vitale plan

52. **Hagia Sophia.** Constantinople (Istanbul). Anthemius of Tralles and Isidorus of Miletus. 532–537 C.E. Brick and ceramic elements with stone and mosaic veneer. (3 images)



Hagia Sophia

© Yann Arthus-Bertrand/Corbis



Hagia Sophia

© De Agostini Picture Library/G. Dagli Orti/The Bridgeman Art Library

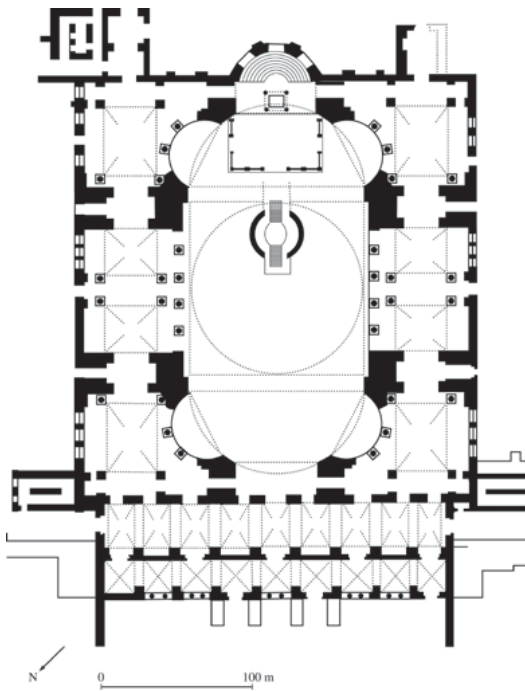

Hagia Sophia plan

53. Merovingian looped fibulae. Early medieval Europe. Mid-sixth century C.E. Silver gilt worked in ftligree, with inlays of garnets and other stones.



Merovingian looped fibulae
© RMN-Grand Palais/Art Resource, NY

54. Virgin (Theotokos) and Child between Saints Theodore and George. Early Byzantine Europe. Sixth or early seventh century C.E. Encaustic on wood.



Virgin (Theotokos) and Child between Saints Theodore and George
© Erich Lessing/Art Resource, NY

55. Lindisfarne Gospels: St. Matthew, cross-carpet page; St. Luke portrait page; St. Luke incipit page. Early medieval (Hiberno Saxon) Europe. c. 700 C.E. Illuminated manuscript (ink, pigments, and gold on vellum). (3 images)



St. Matthew, cross-carpet page
© British Library Board/Robana/Art Resource, NY



St. Luke portrait page
© British Library Board/Robana/Art Resource, NY

Lindisfarne Gospels: St. Matthew, cross-carpet page;
St. Luke portrait page; St. Luke incipit page, *continued*



St. Luke incipit page

© Art Resource, NY

56. **Great Mosque.** Córdoba, Spain. Umayyad. Begun c. 785–786 C.E. Stone masonry.
(5 images)



Great Mosque

© Toni Castillo/Getty Images



Great Mosque

© Ken Welsh/The Bridgeman Art Library

Great Mosque, *continued*



Great Mosque arches
© The Bridgeman Art Library

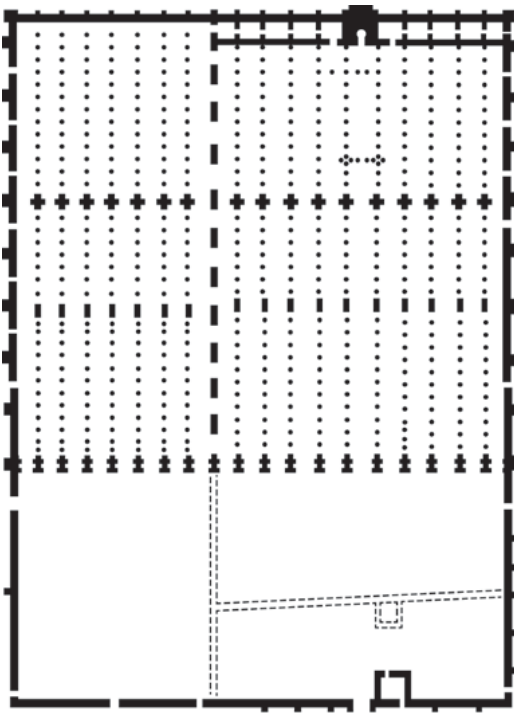

Great Mosque plan
N 0 50 m

57. Pyxis of al-Mughira. Umayyad.
c. 968 C.E. Ivory.



Pyxis of al-Mughira
© RMN-Grand Palais/Art Resource, NY

58. **Church of Sainte-Foy.** Conques, France. Romanesque Europe. Church: c. 1050–1130 C.E.; Reliquary of Saint Foy: ninth century C.E., with later additions. Stone (architecture); stone and paint (tympanum); gold, silver, gemstones, and enamel over wood (reliquary). (4 images)

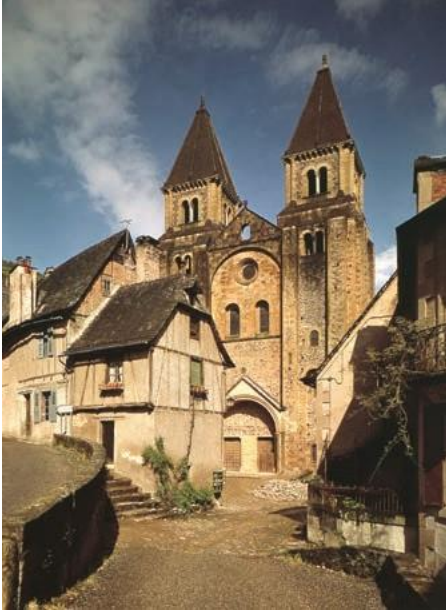

Church of Sainte-Foy
© Scala/Art Resource, NY

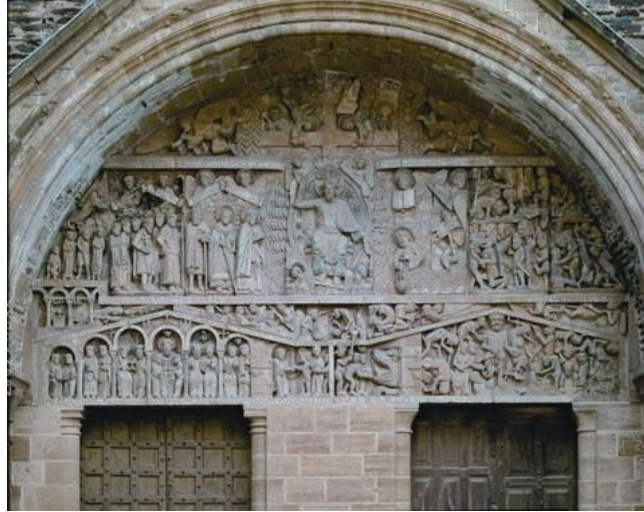

The Last Judgment
© Peter Willi/The Bridgeman Art Library



Church of Sainte-Foy
© The Bridgeman Art Library



Reliquary of Sainte-Foy
© Gianni Dagli Orti/The Art Archive at Art Resource, NY

59. **Bayeux Tapestry.** Romanesque Europe (English or Norman). c. 1066–1080 C.E. Embroidery on linen. (2 images)



First meal

© Erich Lessing/Art Resource, NY

60. **Chartres Cathedral.** Chartres, France. Gothic Europe. Original construction c. 1145–1155 C.E.; reconstructed c. 1194–1220 C.E. Limestone, stained glass. (6 images)



Chartres Cathedral

© Alinari Archives/Corbis

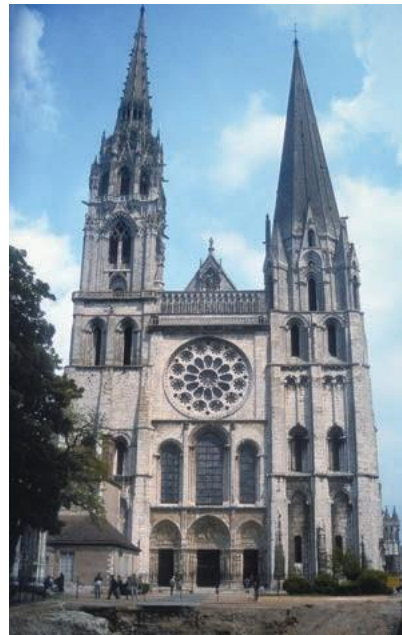

Chartres Cathedral

© Vanni Archive/Art Resource, NY

Chartres Cathedral, *continued*



Great Portal of the West Facade

© Scala/White Images/Art Resource, NY



Chartres Cathedral

© Paul Maeyaert/The Bridgeman Art Library



Notre Dame de la Belle Verriere window

© Anthony Scibilia/Art Resource, NY

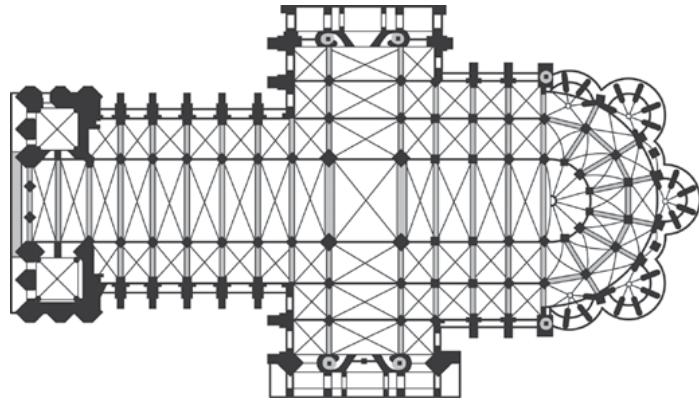

Chartres Cathedral plan

61. Dedication Page with Blanche of Castile and King Louis IX of France, Scenes from the Apocalypse from *Bibles moralisées*. Gothic Europe. c. 1225–1245 C.E. Illuminated manuscript (ink, tempera, and gold leaf on vellum). (2 images, each from a separate manuscript)



Dedication Page with Blanche of Castile and King Louis IX of France

© The Pierpont Morgan Library/Art Resource, NY



Scenes from the Apocalypse

© British Library/Robana/Hulton Fine Art Collection/Getty Images

62. *Röttgen Pietà*. Late medieval Europe. c. 1300–1325 C.E. Painted wood.



Röttgen Pietà

© Erich Lessing/Art Resource, NY

63. Arena (Scrovegni) Chapel, including *Lamentation*. Padua, Italy. Unknown architect; Giotto di Bondone (artist). Chapel: c. 1303 C.E.; Fresco: c. 1305. Brick (architecture) and fresco. (3 images)



Arena (Scrovegni) Chapel

© Alfredo Dagli Orti/The Art Archive at Art Resource, NY



Arena (Scrovegni) Chapel

© Scala/Art Resource, NY



Lamentation

© Scala/Art Resource, NY

64. Golden Haggadah (The Plagues of Egypt, Scenes of Liberation, and Preparation for Passover). Late medieval Spain. c. 1320 C.E. Illuminated manuscript (pigments and gold leaf on vellum). (3 images)



Scenes of Liberation

© The British Library Board, Add. 27210, f.14v



Preparation for Passover

© The British Library Board, Add. 27210, f.14v

65. **Alhambra.** Granada, Spain. Nasrid Dynasty. 1354–1391 C.E. Whitewashed adobe stucco, wood, tile, paint, and gilding. (4 images)

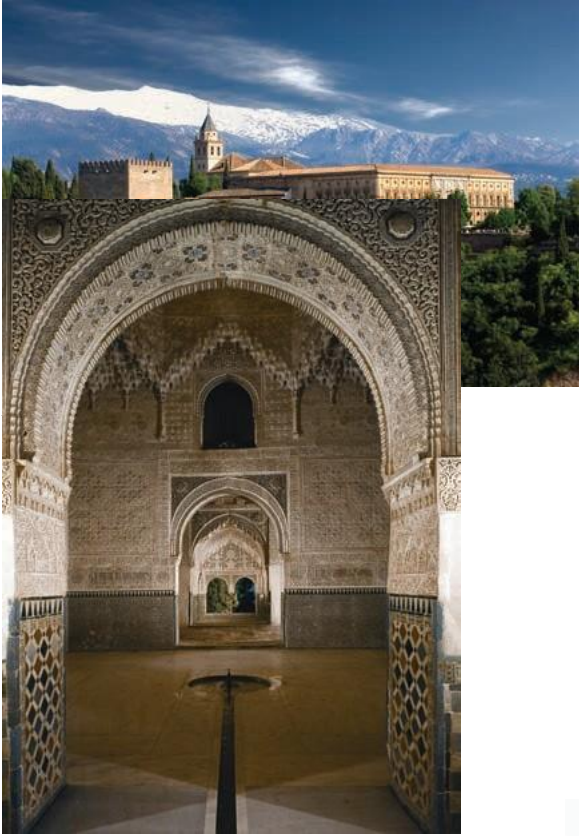

Hall of the Sisters

© Raffaello Bencini/The Bridgeman Art Library



Court of the Lions

© Gianni Dagli Orti/The Art Archive at Art Resource, NY

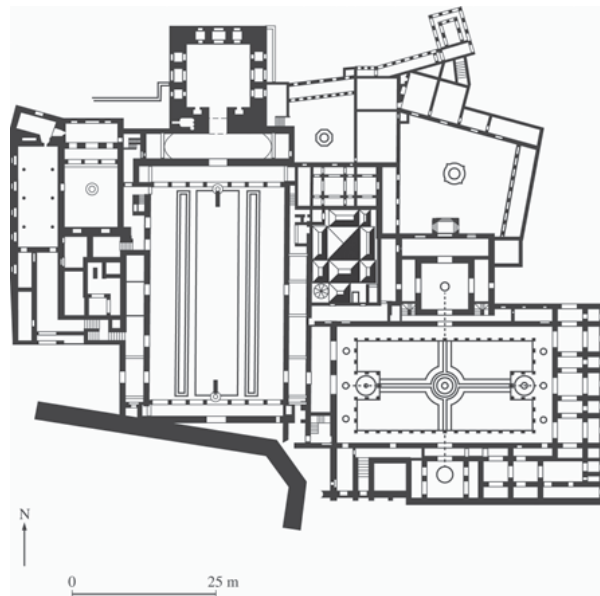

Alhambra plan

66. **Annunciation Triptych (Merode Altarpiece)**. Workshop of Robert Campin. 1427–1432 C.E. Oil on wood.



Annunciation Triptych

Image © The Metropolitan Museum of Art/Image Source © Art Resource, NY

67. **Pazzi Chapel**. Basilica di Santa Croce. Florence, Italy. Filippo Brunelleschi (architect). c. 1429–1461 C.E. Masonry. (2 images)



Pazzi Chapel

© Erich Lessing/Art Resource, NY



Pazzi Chapel

© Scala/Art Resource, NY

68. **The Arnolfini Portrait.** Jan van Eyck. c. 1434 C.E. Oil on wood.



The Arnolfini Portrait
© National Gallery, London, UK/The Bridgeman Art Library

69. **David.** Donatello. c. 1440–1460 C.E. Bronze.



David
© Scala/Art Resource, NY

70. **Palazzo Rucellai.** Florence, Italy. Leon Battista Alberti (architect). c. 1450 C.E. Stone, masonry.



Palazzo Rucellai
© Scala/Art Resource, NY

71. **Madonna and Child with Two Angels.** Fra Filippo Lippi. c. 1465 C.E. Tempera on wood.



Madonna and Child with Two Angels
© Erich Lessing/Art Resource, NY

72. *Birth of Venus*. Sandro Botticelli.
c. 1484–1486 C.E. Tempera on canvas.



Birth of Venus
© Erich Lessing/Art Resource, NY

73. *Last Supper*. Leonardo da Vinci.
c. 1494–1498 C.E. Oil and tempera.



Last Supper
© The Bridgeman Art Library

74. *Adam and Eve*. Albrecht Dürer.
1504 C.E. Engraving.



Adam and Eve
© Bridgeman-Giraudon/Art Resource, NY

75. **Sistine Chapel ceiling and altar wall frescoes.** Vatican City, Italy. Michelangelo. Ceiling frescoes: c. 1508–1512 C.E.; altar frescoes: c. 1536–1541 C.E. Fresco. (4 images)



Sistine Chapel
© The Bridgeman Art Library



The Delphic Sibyl
© Erich Lessing/Art Resource, NY



The Flood
© Erich Lessing/Art Resource, NY

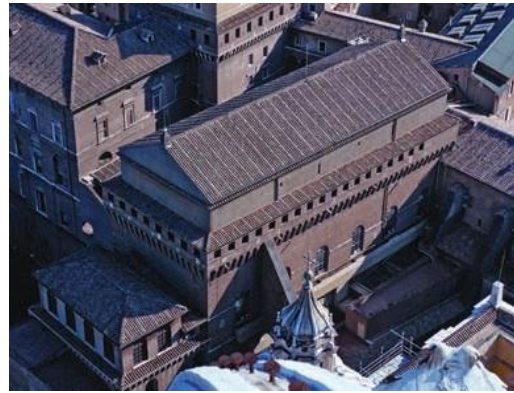

Sistine Chapel
© Reinhard Dirscherl/Alamy

76. *School of Athens*. Raphael. 1509–1511 C.E. Fresco.



School of Athens

© The Bridgeman Art Library Ltd./Alamy

77. *Isenheim altarpiece*. Matthias Grünewald. c. 1512–1516 C.E. Oil on wood. (2 images)



Isenheim altarpiece, closed

© Erich Lessing/Art Resource, NY



Isenheim altarpiece, open

© Scala/Art Resource, NY

78. **Entombment of Christ.** Jacopo da Pontormo. 1525–1528 C.E. Oil on wood.



Entombment of Christ

© De Agostini Picture Library/The Bridgeman Art Library

79. **Allegory of Law and Grace.** Lucas Cranach the Elder. c. 1530 C.E. Woodcut and letterpress.

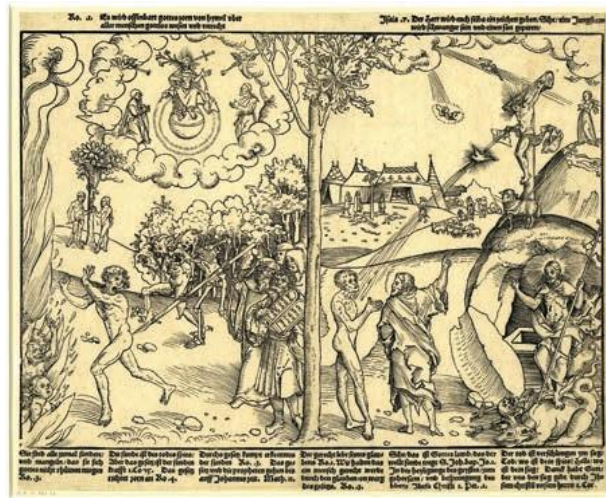

Allegory of Law and Grace

© The Trustees of the British Museum/Art Resource, NY

80. **Venus of Urbino.** Titian. c. 1538 C.E. Oil on canvas.



Venus of Urbino

© Scala/Ministero per i Beni e la Attività culturali/Art Resource, NY

81. **Frontispiece of the Codex Mendoza.** Viceroyalty of New Spain. c. 1541–1542 C.E. Ink and color on paper.



Frontispiece of the Codex Mendoza

© The Bodleian Libraries, The University of Oxford

82. **Il Gesù**, including ***Triumph of the Name of Jesus*** ceiling fresco. Rome, Italy. Giacomo da Vignola, plan (architect); Giacomo della Porta, facade (architect); Giovanni Battista Gaulli, ceiling fresco (artist). Church: 16th century C.E.; facade: 1568–1584 C.E.; fresco and stucco figures: 1676–1679 C.E. Brick, marble, fresco, and stucco. (3 images)



Il Gesù
© Scala/Art Resource, NY



Il Gesù
© Scala/Art Resource, NY



Triumph of the Name of Jesus
© The Bridgeman Art Library

83. ***Hunters in the Snow***. Pieter Bruegel the Elder. 1565 C.E. Oil on wood.



Hunters in the Snow
© The Art Archive at Art Resource, NY

84. **Mosque of Selim II.** Edirne, Turkey. Sinan (architect). 1568–1575 C.E. Brick and stone. (3 images)



Mosque of Selim II

© Giraudon/The Bridgeman Art Library



Mosque of Selim II

© Vanni Archive/Art Resource, NY

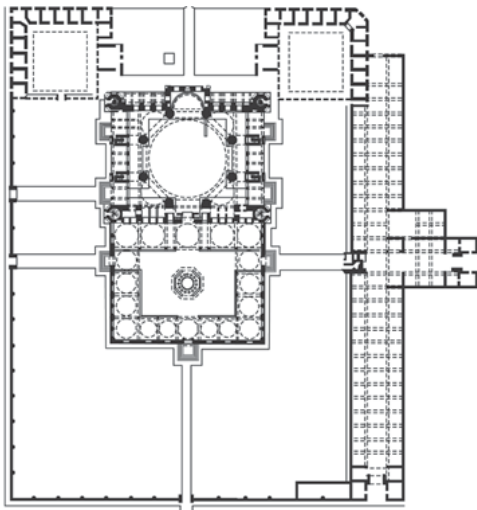

Mosque of Selim II plan

85. **Calling of Saint Matthew.** Caravaggio. c. 1597–1601 C.E. Oil on canvas.



Calling of Saint Matthew

© Scala/Art Resource, NY

86. *Henri IV Receives the Portrait of Marie de' Medici*, from the Marie de' Medici Cycle. Peter Paul Rubens. 1621–1625 C.E. Oil on canvas.



Henri IV Receives the Portrait of Marie de' Medici

© RMN-Grand Palais/Art Resource, NY

87. *Self-Portrait with Saskia*. Rembrandt van Rijn. 1636 C.E. Etching.



Self-Portrait with Saskia

© The Pierpont Morgan Library/Art Resource, NY

88. *San Carlo alle Quattro Fontane*. Rome, Italy. Francesco Borromini (architect). 1638–1646 C.E. Stone and stucco. (3 images)



San Carlo alle Quattro Fontane

© Scala/Art Resource, NY



San Carlo alle Quattro Fontane

© Andrea Jemolo/Scala/Art Resource, NY

San Carlo alle Quattro Fontane, *continued*

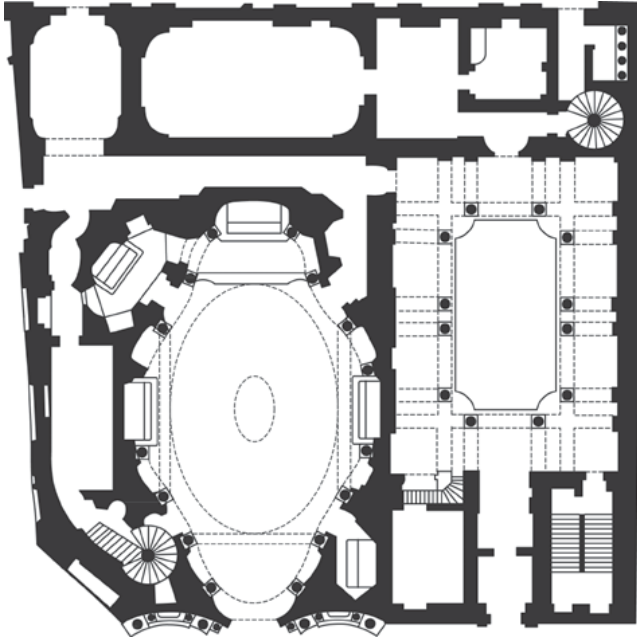

San Carlo alle Quattro Fontane plan

89. ***Ecstasy of Saint Teresa.*** Cornaro Chapel, Church of Santa Maria della Vittoria. Rome, Italy. Gian Lorenzo Bernini. c. 1647–1652 C.E. Marble (sculpture); stucco and gilt bronze (chapel). (3 images)



Church of Santa Maria della Vittoria

© ANDREW MEDICHINI/AP/Corbis



Cornaro Chapel

© Nimatallah/Art Resource, NY

Ecstasy of Saint Teresa, continued



Ecstasy of Saint Teresa

© Nimatallah/Art Resource, NY

90. Angel with Arquebus, Asiel Timor Dei. Master of Calamarca (La Paz School).
c. 17th century C.E. Oil on canvas.



Angel with Arquebus, Asiel Timor Dei

© Paul Maeyaert/The Bridgeman Art Library

91. Las Meninas. Diego Velázquez.
c. 1656 C.E. Oil on canvas.



Las Meninas

© Erich Lessing/Art Resource, NY

92. Woman Holding a Balance. Johannes Vermeer.
c. 1664 C.E. Oil on canvas.



Woman Holding a Balance

© National Gallery of Art, Washington D.C., USA/The Bridgeman Art Library

93. The Palace at Versailles. Versailles, France. Louis Le Vau and Jules Hardouin-Mansart (architects). Begun 1669 C.E. Masonry, stone, wood, iron, and gold leaf (architecture); marble and bronze (sculpture); gardens. (5 images)



The Palace at Versailles
© Yann Arthus-Bertrand/ALTTITUDE



The Palace at Versailles
© RMN-Grand Palais/Art Resource, NY



Courtyard
© Warren Jacobi/Corbis



Hall of Mirrors
© RMN-Grand Palais/Art Resource, NY

The Palace at Versailles, *continued*



Gardens

© Adam Woolfitt/Corbis

94. Screen with the Siege of Belgrade and hunting scene. Circle of the González Family. c. 1697–1701 C.E. Tempera and resin on wood, shell inlay. (2 images)



Siege of Belgrade

© González Family. *Folding Screen with the Siege of Belgrade (front) and Hunting Scene (reverse)*, ca.1697-1701. Oil on wood, inlaid with mother-of-pearl, 90 1/2 x 108 5/8 in. (229.9 x 275.8 cm). Brooklyn Museum, Gift of Lilla Brown in memory of her husband John W. Brown, by exchange, 2012.21



Hunting scene

© González Family. *Folding Screen with the Siege of Belgrade (front) and Hunting Scene (reverse)*, ca.1697-1701. Oil on wood, inlaid with mother-of-pearl, 90 1/2 x 108 5/8 in. (229.9 x 275.8 cm). Brooklyn Museum, Gift of Lilla Brown in memory of her husband John W. Brown, by exchange, 2012.21

95. *The Virgin of Guadalupe (Virgen de Guadalupe)*. Miguel González. c. 1698 C.E. Based on original Virgin of Guadalupe. Basilica of Guadalupe, Mexico City. 16th century C.E. Oil on canvas on wood, inlaid with mother-of-pearl.



Virgen de Guadalupe

Digital Image © 2011 Museum Associates/LACMA. Licensed by Art Resource, NY

96. *Fruit and Insects*. Rachel Ruysch. 1711 C.E. Oil on wood.



Fruit and Insects

© Galleria degli Uffizi, Florence, Italy/The Bridgeman Art Library

97. *Spaniard and Indian Produce a Mestizo*. Attributed to Juan Rodríguez Juárez. c. 1715 C.E. Oil on canvas.



Spaniard and Indian Produce a Mestizo

© Breamore House, Hampshire, UK/The Bridgeman Art Library

98. *The Tête à Tête*, from *Marriage à la Mode*. William Hogarth. c. 1743 C.E. Oil on canvas.



The Tête à Tête

© National Gallery, London, UK/The Bridgeman Art Library

99. **Portrait of Sor Juana Inés de la Cruz.** Miguel Cabrera. c. 1750 C.E. Oil on canvas.



Portrait of Sor Juana Inés de la Cruz
© Jean-Pierre Courau/The Bridgeman Art Library

100. **A Philosopher Giving a Lecture on the Orrery.** Joseph Wright of Derby. c. 1763–1765 C.E. Oil on canvas.



A Philosopher Giving a Lecture on the Orrery
© The Bridgeman Art Library

101. **The Swing.** Jean-Honoré Fragonard. 1767 C.E. Oil on canvas.



The Swing
© Wallace Collection, London, UK/The Bridgeman Art Library

102. Monticello. Virginia, U.S. Thomas Jefferson (architect). 1768–1809 C.E. Brick, glass, stone, and wood. (2 images)



Monticello
© David Muenker/Alamy

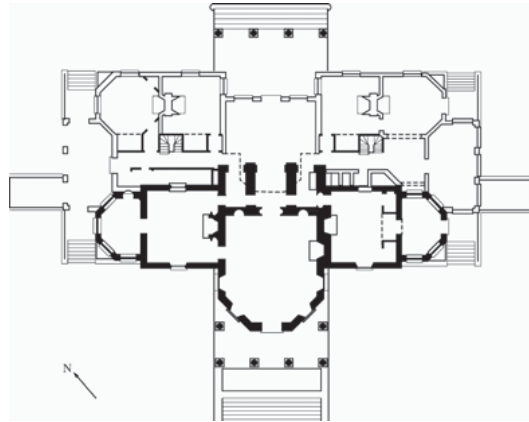

Monticello plan

103. *The Oath of the Horatii*. Jacques-Louis David. 1784 C.E. Oil on canvas.



The Oath of the Horatii
© Gianni Dagli Orti/The Art Archive at Art Resource, NY

104. *George Washington*. Jean-Antoine Houdon. 1788–1792 C.E. Marble.



George Washington
© Buddy Mays/Corbis

105. **Self-Portrait.** Elisabeth Louise Vigée Le Brun. 1790 C.E. Oil on canvas.



Self-Portrait

© Galleria degli Uffizi, Florence, Italy/The Bridgeman Art Library

106. **Y no hai remedio (And There's Nothing to Be Done),** from *Los Desastres de la Guerra (The Disasters of War)*, plate 15. Francisco de Goya. 1810–1823 C.E. (published 1863). Etching, drypoint, burin, and burnishing.

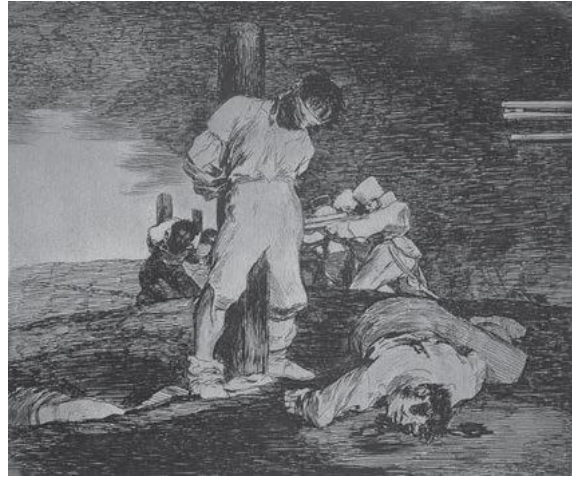

Y no hai remedio

© Private Collection/Index/The Bridgeman Art Library

107. **La Grande Odalisque.** Jean-Auguste-Dominique Ingres. 1814 C.E. Oil on canvas.



La Grande Odalisque

© Giraudon/The Bridgeman Art Library

108. **Liberty Leading the People.** Eugène Delacroix. 1830 C.E. Oil on canvas.



Liberty Leading the People

© Erich Lessing/Art Resource, NY

109. *The Oxbow (View from Mount Holyoke, Northampton, Massachusetts, after a Thunderstorm)*. Thomas Cole. 1836 C.E. Oil on canvas.



The Oxbow (View from Mount Holyoke, Northampton, Massachusetts, after a Thunderstorm)

Image © The Metropolitan Museum of Art/Image source © Art Resource, NY

110. *Still Life in Studio*. Louis-Jacques-Mandé Daguerre. 1837 C.E. Daguerreotype.



Still Life in Studio

© Louis Daguerre/Time & Life Pictures/Getty Images

111. *Slave Ship (Slavers Throwing Overboard the Dead and Dying, Typhoon Coming On)*. Joseph Mallord William Turner. 1840 C.E. Oil on canvas.



Slave Ship (Slavers Throwing Overboard the Dead and Dying, Typhoon Coming On)

Photograph © 2013 Museum of Fine Arts, Boston

112. Palace of Westminster (Houses of Parliament). London, England. Charles Barry and Augustus W. N. Pugin (architects). 1840–1870 C.E. Limestone masonry and glass. (3 images)



Central Lobby
© Adam Woolfit/Corbis



Westminster Hall
© Adam Woolfit/Corbis

113. *The Stone Breakers*. Gustave Courbet. 1849 C.E. (destroyed in 1945). Oil on canvas.



The Stone Breakers
© Staatliche Kunstsammlungen Dresden/The Bridgeman Art Library

114. **Nadar Raising Photography to the Height of Art.** Honoré Daumier. 1862 C.E. Lithograph.



Nadar Raising Photography to the Height of Art

© The Stapleton Collection/The Bridgeman Art Library

115. **Olympia.** Édouard Manet. 1863 C.E. Oil on canvas.



Olympia

© The Gallery Collection/Corbis

116. **The Saint-Lazare Station.** Claude Monet. 1877 C.E. Oil on canvas.



The Saint-Lazare Station

© Musée d'Orsay, Paris, France/The Bridgeman Art Library

117. **The Horse in Motion.** Eadweard Muybridge. 1878 C.E. Albumen print.



The Horse in Motion

Courtesy of the Library of Congress # LC-USZ62-58070

118. **The Valley of Mexico from the Hillside of Santa Isabel (El Valle de México desde el Cerro de Santa Isabel)**, Jose María Velasco. 1882 C.E. Oil on canvas.



El Valle de México desde el Cerro de Santa Isabel

© Art Resource, NY

119. **The Burghers of Calais**, Auguste Rodin. 1884–1895 C.E. Bronze.



The Burghers of Calais

© Scala/Art Resource, NY

120. **The Starry Night**, Vincent van Gogh. 1889 C.E. Oil on canvas.



The Starry Night

Digital Image © The Museum of Modern Art/Licensed by SCALA/Art Resource, NY

121. **The Coiffure**, Mary Cassatt. 1890–1891 C.E. Drypoint and aquatint.



The Coiffure

Used by Permission

122. *The Scream*. Edvard Munch. 1893 C.E. Tempera and pastels on cardboard.

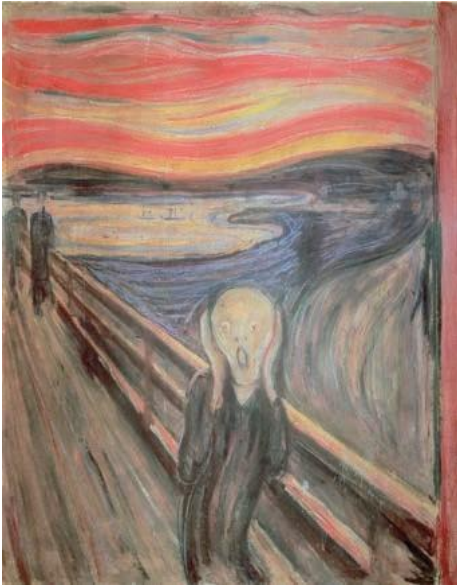

The Scream

Digital Image © Bridgeman Art Library © 2013 The Munch Museum/The Munch-Ellingsen Group/Artists Rights Society (ARS), New York

123. *Where Do We Come From? What Are We? Where Are We Going?* Paul Gauguin. 1897–1898 C.E. Oil on canvas.



Where Do We Come From? What Are We? Where Are We Going?

Photograph © 2013 Museum of Fine Arts, Boston

124. *Carson, Pirie, Scott and Company Building*. Chicago, Illinois, U.S. Louis Sullivan (architect). 1899–1903 C.E. Iron, steel, glass, and terra cotta. (3 images)



Carson, Pirie, Scott and Company Building

© Hedrich Blessing Collection/Chicago History Museum/Getty Images



Detail

© Raymond Boyd/Michael Ochs Archives/Getty Images

Carson, Pirie, Scott and Company Building,
continued

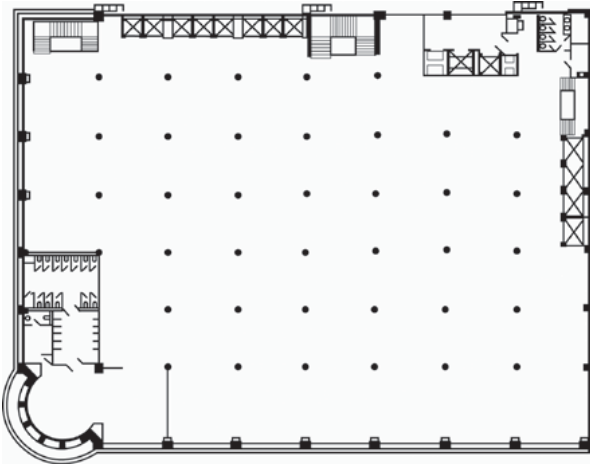

Carson, Pirie, Scott and Company Building
plan

125. **Mont Sainte-Victoire.** Paul
Cézanne. 1902–1904 C.E. Oil on canvas.



Mont Sainte-Victoire

© The Philadelphia Museum of Art/Art Resource, NY

126. **Les Femmes d'Alger (O.J.)** Pablo
Picasso. 1907 C.E. Oil on canvas.



Les Femmes d'Alger (O.J.)

Digital Image © Bridgeman Art Library © Estate of Pablo Picasso/2013 Artists
Rights Society (ARS), New York

127. **The Steerage.** Alfred Stieglitz.
1907 C.E. Photogravure.

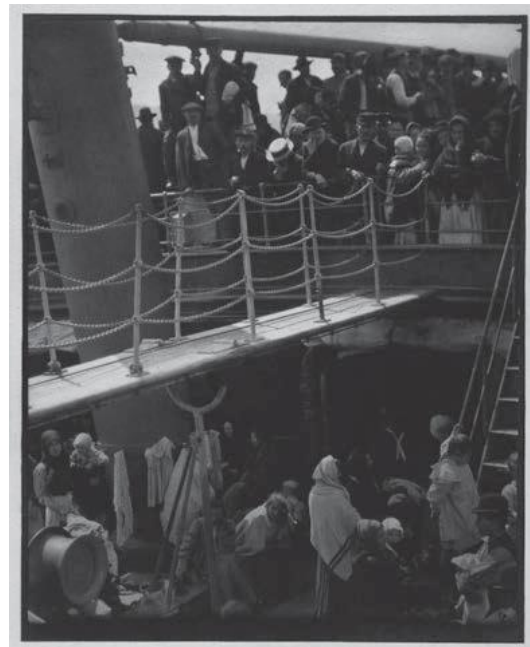

The Steerage

© RMN-Grand Palais/Art Resource, NY © Georgia O'Keefe Museum/Artists
Rights Society (ARS), New York

128. **The Kiss.** Gustav Klimt. 1907–1908 C.E.
Oil and gold leaf on canvas.

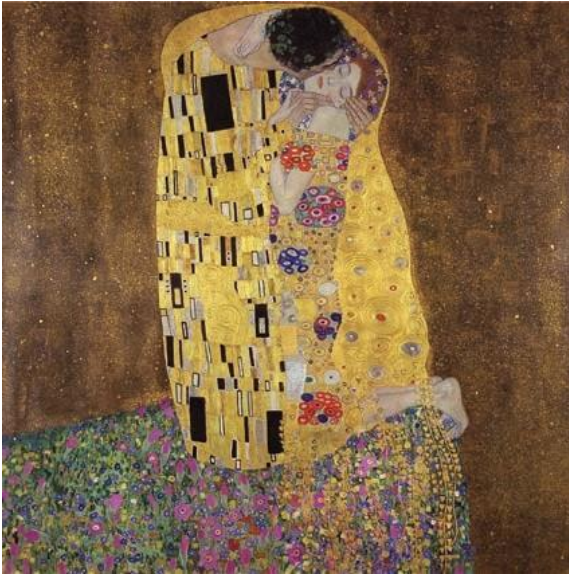

The Kiss
© The Gallery Collection/Corbis

129. **The Kiss.** Constantin Brancusi. Original 1907–1908 C.E. Stone.



The Kiss (1916 version)
© Album/Art Resource, NY © 2013 Artists Rights Society (ARS),
New York/ADAGP, Paris

130. **The Portuguese.** Georges Braque. 1911 C.E. Oil on canvas.



The Portuguese
Photo © Bridgeman-Giraudon/Art Resource, NY © 2013 Artists
Rights Society (ARS), New York/ADAGP, Paris

131. **Goldfish.** Henri Matisse. 1912 C.E.
Oil on canvas.



Goldfish
© Alexander Burkatovski/Corbis

132. *Improvisation 28 (second version).* Vassily Kandinsky. 1912 C.E. Oil on canvas.



Improvisation 28 (second version)

Digital Image © The Bridgeman Art Library © 2013 Artists Rights Society (ARS), New York/ADAGP, Paris

133. *Self-Portrait as a Soldier.* Ernst Ludwig Kirchner. 1915 C.E. Oil on canvas.

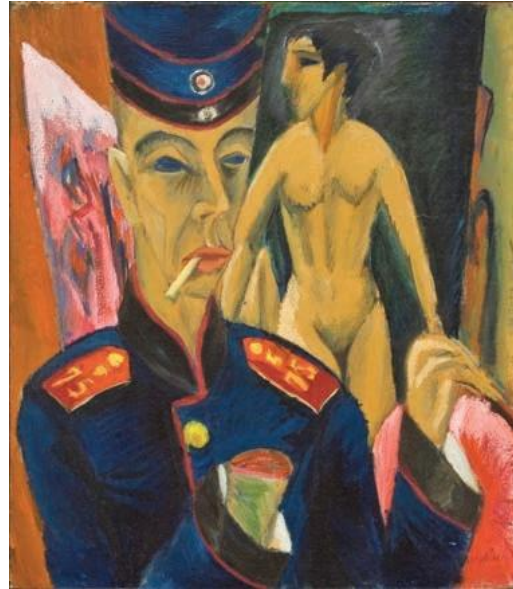

Self-Portrait as a Soldier

© Allen Memorial Art Museum, Oberlin College, Ohio, USA/Charles F. Olney Fund/The Bridgeman Art Library

134. *Memorial Sheet for Karl Liebkecht.* Käthe Kollwitz. 1919–1920 C.E. Woodcut.



Memorial Sheet for Karl Liebkecht

Photo © Snark/Licensed by SCALA/Art Resource, NY © 2013 Artists Rights Society (ARS), New York/ProLitteris, Zurich

135. **Villa Savoye.** Poissy-sur-Seine, France. Le Corbusier (architect). 1929 C.E. Steel and reinforced concrete. (2 images)



Villa Savoye

Digital Image © Bridgeman Art Library © Artists Rights Society (ARS), New York/ADAGP, Paris/F.L.C



Villa Savoye

© Anthony Scibilia/Art Resource, NY © Artists Rights Society (ARS), New York/ADAGP, Paris/F.L.C

136. **Composition with Red, Blue and Yellow.** Piet Mondrian. 1930 C.E. Oil on canvas.

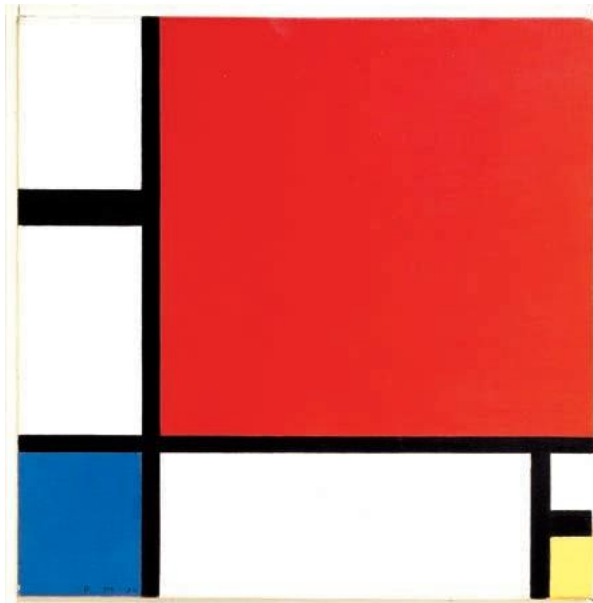

Composition with Red, Blue and Yellow

Piet Mondrian (1872-1944) *Composition with Red, Blue and Yellow*, 1930
© 2013 Mondrian/Holtzman Trust c/o HCR International USA/Photo
© 2013 Erich Lessing/Art Resource, NY

137. Illustration from ***The Results of the First Five-Year Plan.*** Varvara Stepanova. 1932 C.E. Photomontage.



Illustration from *The Results of the First Five-Year Plan*

© The Gallery Collection/Corbis

138. Object (*Le Déjeuner en fourrure*), Meret Oppenheim.
1936 C.E. Fur-covered cup, saucer, and spoon.



Object (Le Déjeuner en fourrure)

Digital Image © 2013 The Museum of Modern Art/Licensed by SCALA/Art Resource, NY ©
2013 Artists Rights Society (ARS), New York/ProLitteris, Zurich

139. Fallingwater. Pennsylvania, U.S. Frank Lloyd Wright (architect). 1936–1939 C.E.
Reinforced concrete, sandstone, steel, and glass. (3 images)



Fallingwater

© Robert P. Ruschak/Courtesy of Western Pennsylvania Conservancy

Fallingwater, continued

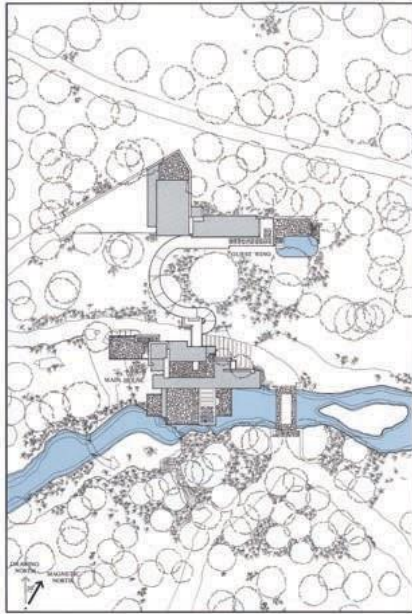

Fallingwater site plan

© Astorino

140. *The Two Fridas*. Frida Kahlo. 1939 C.E. Oil on canvas.



The Two Fridas

© Schalkwijk/Art Resource, NY © 2013 Banco de México Diego Rivera Frida Kahlo Museums Trust, Mexico, D.F./Artists Rights Society (ARS), New York

141. *The Migration of the Negro, Panel no. 49*. Jacob Lawrence. 1940–1941 C.E. Casein tempera on hardboard.



The Migration of the Negro, Panel no. 49

© The Phillips Collection, Washington, DC © 2013 The Jacob and Gwendolyn Lawrence Foundation, Seattle/Artists Rights Society (ARS), New York

142. *The Jungle*. Wifredo Lam. 1943 C.E. Gouache on paper mounted on canvas.



The Jungle

Photo © 2013 The Museum of Modern Art/Licensed by SCALA/ Art Resource, NY © 2013 Artists Rights Society (ARS), New York/ ADAGP, Paris

143. *Dream of a Sunday Afternoon in the Alameda Park*. Diego Rivera. 1947–1948 C.E. Fresco.



Dream of a Sunday Afternoon in the Alameda Park

© Alfredo Dagli Orti/Art Resource, NY © 2013 Banco de México Diego Rivera Frida Kahlo Museums Trust, Mexico, D.F./Artists Rights Society (ARS), New York

144. *Fountain* (second version). Marcel Duchamp. 1950 C.E. (original 1917). Readymade glazed sanitary china with black paint.



Fountain (second version)

Photo © The Philadelphia Museum of Art/Art Resource, NY © Succession Marcel Duchamp/ADAGP, Paris/Artists Rights Society (ARS), New York 2013

145. *Woman, I*. Willem de Kooning. 1950–1952 C.E. Oil on canvas.



Woman, I

Photo © 2013 The Museum of Modern Art/Licensed by SCALA/Art Resource, NY © 2013 The Willem de Kooning Foundation/Artists Rights Society (ARS), New York

146. *Seagram Building*. New York City, U.S. Ludwig Mies van der Rohe and Philip Johnson (architects). 1954–1958 C.E. Steel frame with glass curtain wall and bronze.



Seagram Building

© Angelo Hornak/Corbis

147. *Marilyn Diptych*. Andy Warhol. 1962 C.E.
Oil, acrylic, and silkscreen enamel on canvas.



Marilyn Diptych

© Tate, London/Art Resource, NY © 2013 The Andy Warhol Foundation for the Visual Arts, Inc./Artists Rights Society (ARS), New York

148. *Narcissus Garden*. Yayoi Kusama. Original installation and performance 1966. Mirror balls.



Narcissus Garden (Paris, 2010 installation)

Courtesy Yayoi Kusama Studio Inc., Ota Fine Arts, Tokyo and Victoria Miro, London © Yayoi Kusama

149. *The Bay*. Helen Frankenthaler. 1963 C.E.
Acrylic on canvas.



The Bay

© Estate of the Artist/2013 Artists Rights Society (ARS), Bridgeman Art Library, New York

150. *Lipstick (Ascending) on Caterpillar Tracks*. Claes Oldenburg. 1969–1974 C.E.
Cor-Ten steel, steel, aluminum, and cast resin; painted with polyurethane enamel.



Lipstick (Ascending) on Caterpillar Tracks

© Used by Permission of the Artist

151. **Spiral Jetty.** Great Salt Lake, Utah, U.S. Robert Smithson. 1970 C.E. Earthwork: mud, precipitated salt crystals, rocks, and water coil.



Spiral Jetty

© The Artist/Licensed by VAGA, New York, NY/Courtesy James Cohan Gallery, New York & Shanghai

152. **House in New Castle County.** Delaware, U.S. Robert Venturi, John Rauch, and Denise Scott Brown (architects). 1978–1983 C.E. Wood frame and stucco. (2 images)



House in New Castle County

© Venturi, Scott Brown Collection/The Architectural Archives, University of Pennsylvania/Photo by Matt Wargo



House in New Castle County

© Venturi, Scott Brown Collection/The Architectural Archives, University of Pennsylvania/Photo by Matt Wargo

153. Chavín de Huántar. Northern highlands, Peru. Chavín. 900–200 B.C.E. Stone (architectural complex); granite (Lanzón and sculpture); hammered gold alloy (jewelry). (4 images)

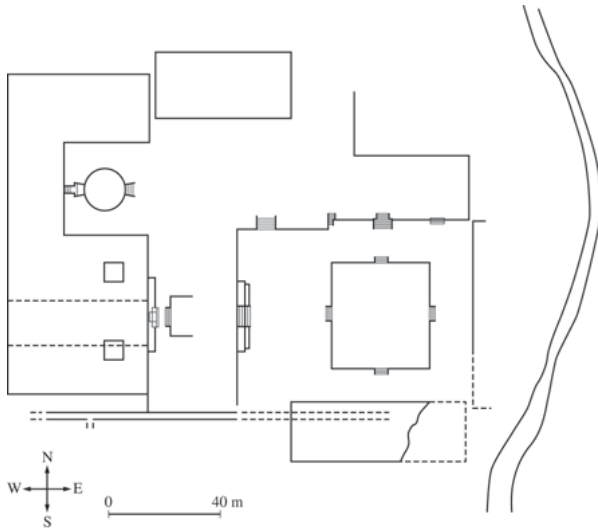

Chavín de Huántar plan



Lanzón Stela

© Richard List/Corbis



Relief sculpture

© Charles & Josette Lenars/Corbis



Nose ornament

Photograph © The Cleveland Museum of Art

154. Mesa Verde cliff dwellings. Montezuma County, Colorado. Ancestral Puebloan (Anasazi). 450–1300 C.E. Sandstone.



Mesa Verde cliff dwellings

© Kerrick James/Corbis

155. Yaxchilán. Chiapas, Mexico. Maya. 725 C.E. Limestone (architectural complex). (3 images)



Structure 40

© vario images GmbH & Co. KG/Alamy



Lintel 25, Structure 23

© Werner Forman/Art Resource, NY

Yaxchilán, *continued*



Structure 33

© Christian Kober/Robert Harding World Imagery/Corbis

156. Great Serpent Mound. Adams County, southern Ohio. Mississippian (Eastern Woodlands). c. 1070 C.E. Earthwork/effigy mound.



Great Serpent Mound

© Richard A. Cooke/Corbis

157. Templo Mayor (Main Temple). Tenochtitlan (modern Mexico City, Mexico). Mexica (Aztec). 1375–1520 C.E. Stone (temple); volcanic stone (The Coyolxauhqui Stone); jadeite (Olmec-style mask); basalt (Calendar Stone). (4 images)



Templo Mayor (reconstruction drawing)

© Archives Larousse, Paris, France/Giraudon/The Bridgeman Art Library



The Coyolxauhqui Stone

© Gianni Dagli Orti/Corbis

Templo Mayor (Main Temple), *continued*



Calendar Stone

© AZA/Archive Zabé/Art Resource, NY



Olmec-style mask

© Gianni Dagli Orti/The Art Archive at Art Resource, NY

158. Ruler's feather headdress (probably of Motecuhzoma II), Mexica (Aztec). 1428–1520 C.E. Feathers (quetzal and cotinga) and gold.



Ruler's feather headdress

© Gianni Dagli Orti/The Art Archive at Art Resource, NY

159. City of Cusco, including Qorikancha (Inka main temple), Santo Domingo (Spanish colonial convent), and Walls at Saqsa Waman (Sacsayhuaman). Central highlands, Peru. Inka. c. 1440 C.E.; convent added 1550–1650 C.E. Andesite. (3 images)

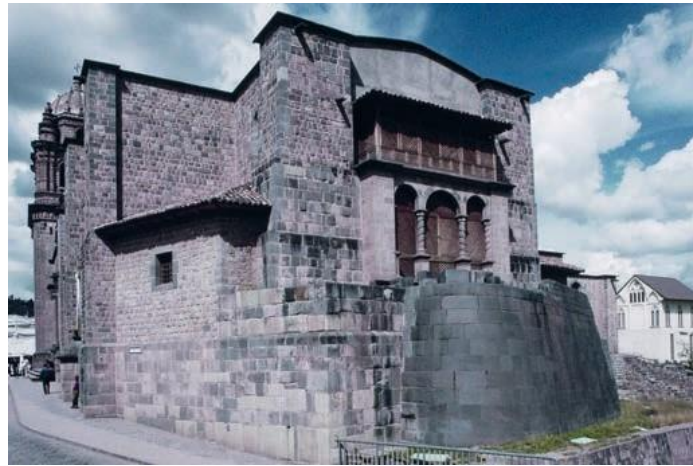
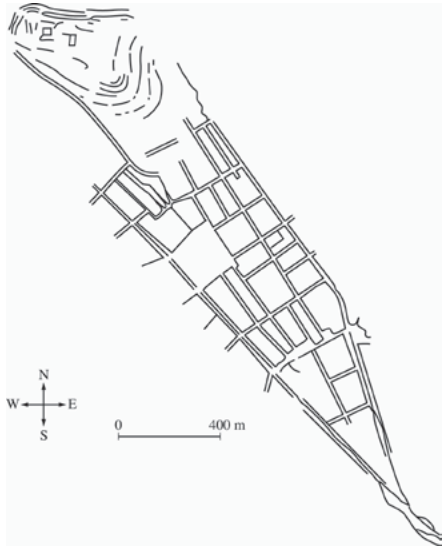

Curved Inka wall of Qorikancha with Santo Domingo convent

© Michael Freeman/Corbis



Walls at Saqsa Waman (Sacsayhuaman)

© Gianni Dagli Orti/The Art Archive at Art Resource, NY

160. Maize cobs. Inka. c. 1440–1533 C.E.
Sheet metal/repoussé, metal alloys.



Maize cobs

© bpk, Berlin/Ethnologisches Museum, Staatliche Museen/Claudia Obrocki/Art Resource, NY

161. City of Machu Picchu. Central highlands, Peru. Inka. c. 1450–1540 C.E. Granite (architectural complex). (3 images)



City of Machu Picchu

© Hugh Sitton/Corbis



Observatory

© Nick Saunders/Barbara Heller Photo Library, London/Art Resource, NY

City of Machu Picchu, *continued*



Intihuatana Stone

© DEA/G. DAGLI ORTI/De Agostini Picture Library/Getty Images

162. All-T'oquepu tunic. Inka. 1450–1540 C.E. Camelid fiber and cotton.



All-T'oquepu tunic

© Dumbarton Oaks, Washington, D.C.

163. Bandolier bag. Lenape (Delaware tribe, Eastern Woodlands). c. 1850 C.E. Beadwork on leather.



Bandolier bag

Used by permission

164. Transformation mask. Kwakwaka'wakw, Northwest coast of Canada. Late 19th century C.E. Wood, paint, and string. (2 images)



Transformation mask, closed
© Musée du Quai Branly/Scala/Art Resource, NY



Transformation mask, open
© Musée du Quai Branly/Scala/Art Resource, NY

165. Painted elk hide. Attributed to Cotsiogo (Cadzi Cody), Eastern Shoshone, Wind River Reservation, Wyoming. c. 1890–1900 C.E. Painted elk hide.



Painted elk hide
Courtesy of School for Advanced Research, Catalog Number SAR.1978-1-87/Photograph by Addison Doty

166. Black-on-black ceramic vessel. Maria Martínez and Julian Martínez, Tewa, Puebloan, San Ildefonso Pueblo, New Mexico. c. mid-20th century C.E. Blackware ceramic.



Black-on-black ceramic vessel
© Barbara Gonzales, Great Granddaughter of Maria and Julian Martínez

167. Conical tower and circular wall of Great Zimbabwe. Southeastern Zimbabwe. Shona peoples. c. 1000–1400 C.E. Coursed granite blocks. (2 images)



Conical tower

© Werner Forman Archive/The Bridgeman Art Library



Circular wall

© Werner Forman Archive/The Bridgeman Art Library

168. Great Mosque of Djenné. Mali. Founded c. 1200 C.E.; rebuilt 1906–1907. Adobe. (2 images)

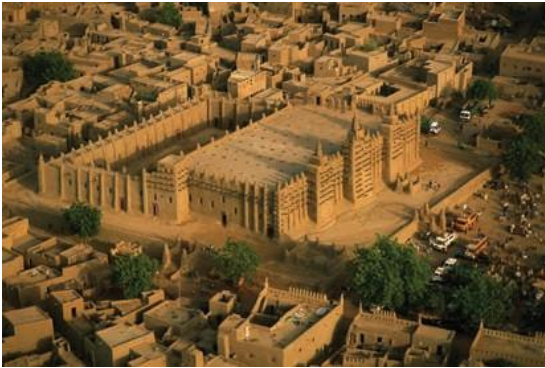

Great Mosque of Djenné

© George Steinmetz/Corbis



Monday market at the Great Mosque of Djenné

© Remi Benali/Corbis

169. Wall plaque, from Oba's palace. Edo peoples, Benin (Nigeria). 16th century C.E. Cast brass. (2 images)



Contextual photograph: Oba of Benin
© Werner Forman/Art Resource, NY

170. *Sika dwa kofi* (Golden Stool). Ashanti peoples (south central Ghana). c. 1700 C.E. Gold over wood and cast-gold attachments. (2 images)



Sika dwa kofi

© Marc Deville/Gamma-Rapho via Getty Images



Contextual photograph: *Sika dwa kofi*

© Marc Deville/Gamma-Rapho via Getty Images

171. **Ndop** (portrait figure) of King Mishe miShyaang maMbul. Kuba peoples (Democratic Republic of the Congo). c. 1760–1780 C.E. Wood. (2 images)



Ndop

© Brooklyn Museum of Art, New York, USA/The Bridgeman Art Library



Contextual photograph: *Ndop*

Kuba Nyim (ruler) Kot a Mbweky III in state dress with royal drum in Mushenge, Democratic Republic of the Congo. Photograph by Eliot Elisofon, 1971. EEPA EECL 2139/Eliot Elisofon Photographic Archives/National Museum of African Art/Smithsonian Institution

172. Power figure (**Nkisi n'kondi**). Kongo peoples (Democratic Republic of the Congo). c. late 19th century C.E. Wood and metal.



Nkisi n'kondi

© Detroit Institute of Arts, USA/Founders Society Purchase/Eleanor Clay Ford Fund for African Art/The Bridgeman Art Library

173. Female (*Pwo*) mask. Chokwe peoples (Democratic Republic of the Congo). Late 19th to early 20th century C.E. Wood, fiber, pigment, and metal.



Female (*Pwo*) mask

Photograph © by Franko Khoury/National Museum of African Art/Smithsonian Institution

174. Portrait mask (*Mblo*). Baule peoples (Côte d'Ivoire). Early 20th century C.E. Wood and pigment. (2 images)



Mblo

© Jerry L. Thompson



Contextual photograph: *Mblo*

Used by Permission

175. **Bundu mask.** Sande Society, Mende peoples (West African forests of Sierra Leone and Liberia). 19th to 20th century C.E. Wood, cloth, and fiber. (2 images)



Bundu mask

© Schomburg Center, NYPL/Art Resource, NY



Contextual photograph: *Bundu mask*

© William Siegmann Estate, Edward DeCarbo, Executor

176. **Ikenga (shrine figure).** Igbo peoples (Nigeria). c. 19th to 20th century C.E. Wood.



Ikenga

© Werner Forman/Art Resource, NY

177. **Lukasa (memory board)**. Mbudye Society, Luba peoples (Democratic Republic of the Congo). c. 19th to 20th century C.E. Wood, beads, and metal. (2 images)



Lukasa

Photo © Heini Schneebeli/The Bridgeman Art Library

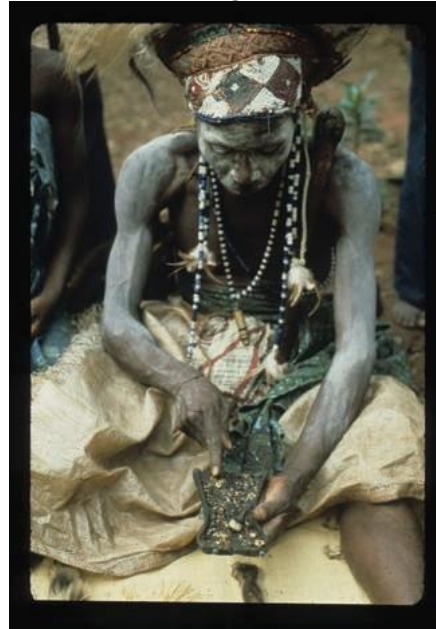

Contextual photograph: *Lukasa*

Courtesy of Mary Nooter Roberts

178. **Aka elephant mask**. Bamileke (Cameroon, western grassfields region). c. 19th to 20th century C.E. Wood, woven raffia, cloth, and beads. (2 images)



Aka elephant mask

Image copyright © The Metropolitan Museum of Art/Image Source
© Art Resource, NY



Contextual photograph: Aka elephant mask

© George Holton/Photo Researchers/Getty Images

179. Reliquary figure (*byeri*). Fang peoples (southern Cameroon). c. 19th to 20th century C.E. Wood.



Reliquary figure (*byeri*)

© Brooklyn Museum/Corbis

180. Veranda post of enthroned king and senior wife (Opo Ogoga). Olowe of Ise (Yoruba peoples). c. 1910–1914 C.E. Wood and pigment.



Veranda post of enthroned king and senior wife (Opo Ogoga)

Used by Permission of the Art Institute of Chicago

181. Petra, Jordan: Treasury and Great Temple. Nabataean Ptolemaic and Roman.
c. 400 B.C.E.–100 C.E. Cut rock. (3 images)



Petra

© De Agostini Picture Library/C. Sappa/The Bridgeman Art Library



Treasury

© Bernard Gagnon



Great Temple

© Bernard Gagnon

182. Buddha. Bamiyan, Afghanistan. Gandharan. c. 400–800 C.E. (destroyed in 2001). Cut rock with plaster and polychrome paint. (2 images)

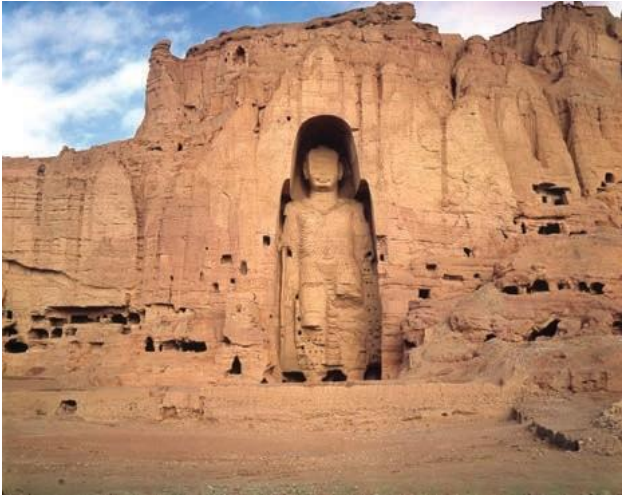

Buddha
© Borromeo/Art Resource, NY



Buddha
© Paul Almasy/Corbis

183. The Kaaba. Mecca, Saudi Arabia. Islamic. Pre-Islamic monument; rededicated by Muhammad in 631–632 C.E.; multiple renovations. Granite masonry, covered with silk curtain and calligraphy in gold and silver-wrapped thread. (3 images)



The Kaaba
© ALI JAREKJI/Reuters/Corbis



The Kaaba
© Kazuyoshi Nomachi/Corbis

The Kaaba, *continued*



Gathering at the Kaaba

© ALI JAREKJI/Reuters/Corbis

184. Jowo Rinpoche, enshrined in the Jokhang Temple. Lhasa, Tibet. Yarlung Dynasty. Believed to have been brought to Tibet in 641 C.E. Gilt metals with semiprecious stones, pearls, and paint; various offerings.



Jowo Rinpoche

© Christophe Boisvieux/Corbis

185. Dome of the Rock. Jerusalem. Islamic, Umayyad. 691–692 C.E., with multiple renovations. Stone masonry and wooden roof decorated with glazed ceramic tile, mosaics, and gilt aluminum and bronze dome. (2 images)



Dome of the Rock

© SEF/Art Resource, NY



Dome of the Rock

© Erich Lessing/Art Resource, NY

186. Great Mosque (Masjid-e Jameh). Isfahan, Iran. Islamic, Persian: Seljuk, Il-Khanid, Timurid and Safavid Dynasties. c. 700 C.E.; additions and restorations in the 14th, 18th, and 20th centuries C.E. Stone, brick, wood, plaster, and glazed ceramic tile. (4 images)

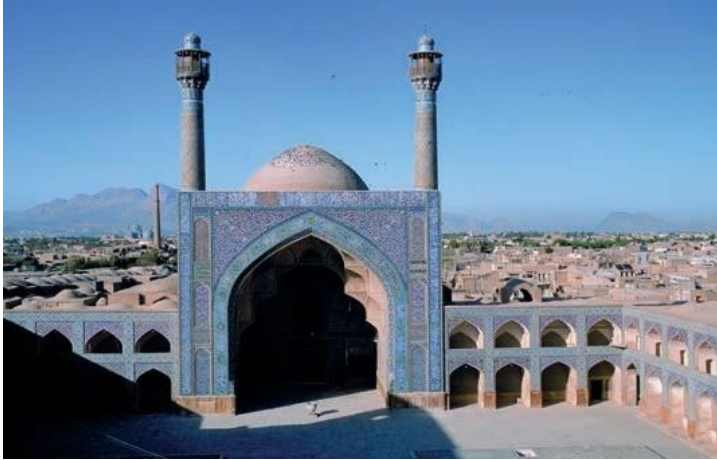

Masjid-e Jameh
© Bruno Morandi/Hemis/Corbis



Detail
© EmmePi Travel/Alamy



Courtyard
© Paule Seux/Hemis/Corbis

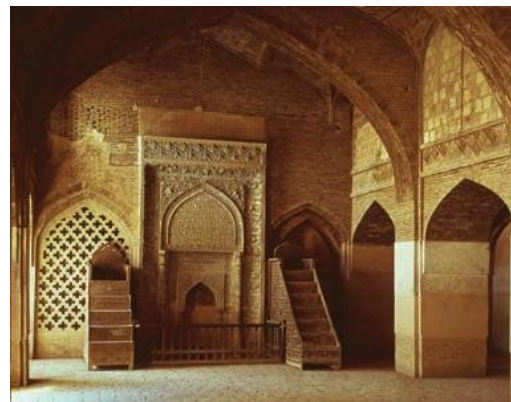

Mihrab (prayer room)
© Gianni Dagli Orti/The Art Archive at Art Resource, NY

187. Folio from a Qur'an. Arab, North Africa, or Near East. Abbasid. c. eighth to ninth century C.E. Ink, color, and gold on parchment.

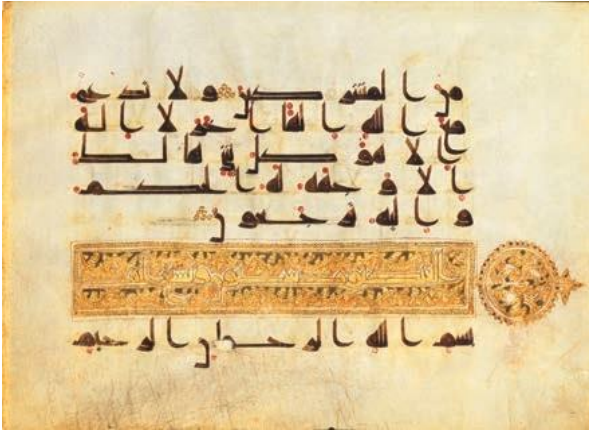

Folio from a Qur'an

© The Pierpont Morgan Library/Art Resource, NY

188. Basin (*Baptistère de St. Louis*). Muhammad ibn al-Zain. c. 1320–1340 C.E. Brass inlaid with gold and silver.



Basin (*Baptistère de St. Louis*)

© Gianni Dagli Orti/The Archive at Art Resource, NY

189. *Bahram Gur Fights the Karg*, folio from the Great Il-Khanid *Shahnama*. Islamic; Persian, Il'Khanid. c. 1330–1340 C.E. Ink and opaque watercolor, gold, and silver on paper.



Bahram Gur Fights the Karg

Reproduction print used by permission of the Harvard Art Museums

190. *The Court of Gayumars*, folio from Shah Tahmasp's *Shahnama*. Sultan Muhammad. c. 1522–1525 C.E. Ink, opaque watercolor, and gold on paper.



The Court of Gayumars

Courtesy of Wikimedia

191. The Ardabil Carpet. Maqsud of Kashan. 1539–1540 C.E. Silk and wool.



The Ardabil Carpet

© Victoria & Albert Museum, London, UK/The Bridgeman Art Library

192. Great Stupa at Sanchi. Madhya Pradesh, India. Buddhist; Maurya, late Sunga Dynasty. c. 300 B.C.E.–100 C.E. Stone masonry, sandstone on dome. (4 images)



Great Stupa at Sanchi

© Atlantide Phototravel/Corbis



Detail

© Atlantide Phototravel/Corbis



North Gate

© Raveesh Vyas

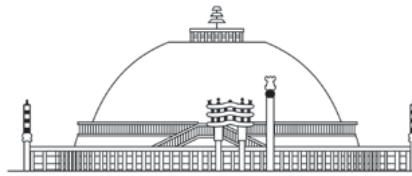
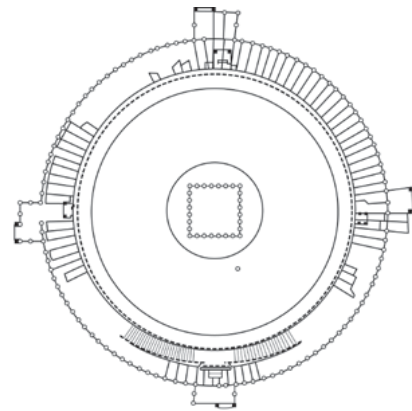

0 15 m

Plan and elevation

193. Terra cotta warriors from mausoleum of the first Qin emperor of China. Qin Dynasty. c. 221–209 B.C.E. Painted terra cotta. (2 images)



Terra cotta warriors
© Imagemore Co., Ltd./Corbis

194. Funeral banner of Lady Dai (Xin Zhui). Han Dynasty, China. c. 180 B.C.E. Painted silk.



Funeral banner of Xin Zhui
© Bettman/Corbis

195. Longmen caves. Luoyang, China. Tang Dynasty. 493–1127 C.E. Limestone.
(3 images)



Longmen caves
© CLARO CORTES IV/Reuters/Corbis



Detail
© Christian Kober/Robert Harding World Imagery/Corbis



Detail
Used by Permission

196. Gold and jade crown. Three Kingdoms Period, Silla Kingdom, Korea. Fifth to sixth century C.E. Metalwork.



Gold and jade crown
© DeA Picture Library/Art Resource, NY

197. Todai-ji. Nara, Japan. Various artists, including sculptors Unkei and Keikei, as well as the Kei School. 743 C.E.; rebuilt c. 1700. Bronze and wood (sculpture); wood with ceramic-tile roofng (architecture). (5 images)



Todai-ji
© Vanni Archive/Art Resource, NY



Great Buddha
© Vanni Archive/Art Resource, NY



Nio guardian statue
© Keith Levit/Alamy



Nio guardian statue
© Alex Ramsay/Alamy

Todai-ji, continued



Gate

© Paulo Fridman/Corbis

198. Borobudur Temple. Central Java, Indonesia. Sailendra Dynasty. c. 750–842 C.E.
Volcanic-stone masonry. (3 images)



Borobudur Temple

© Charles & Josette Lenars/Corbis



Detail

© Edifice/Corbis

Borobudur Temple, *continued*



Buddha

© Dallas and John Heaton/Free Agents 1 Limited/Corbis

199. Angkor, the temple of Angkor Wat, and the city of Angkor Thom, Cambodia. Hindu, Angkor Dynasty. c. 800–1400 C.E. Stone masonry, sandstone. (5 images)



South Gate of Angkor Thom

© Christophe Boisvieux/Corbis

Angkor, the temple of Angkor Wat, and the city of Angkor Thom, Cambodia, *continued*

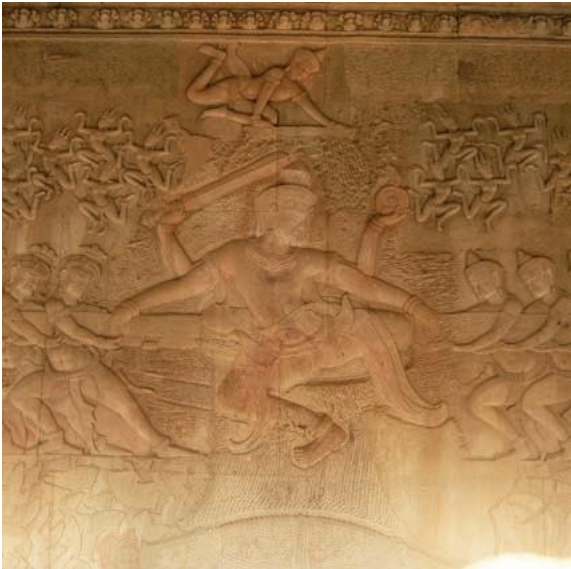

Churning of the Ocean of Milk

© Kevin R. Morris/Corbis



Jayavarman VII as Buddha

HansStieglitz@t-online.de

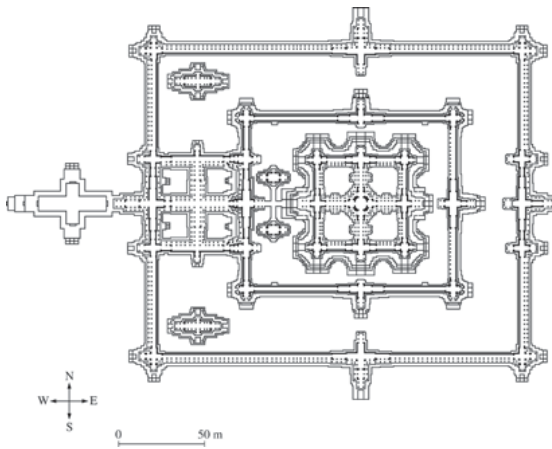

Angkor Wat plan

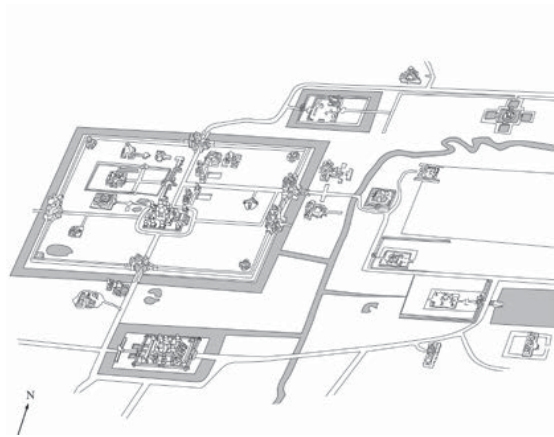

Angkor site plan

200. Lakshmana Temple. Khajuraho, India. Hindu, Chandella Dynasty. c. 930–950 C.E. Sandstone. (4 images)



Lakshmana Temple
© Jose Fuste Raga/Corbis



Detail
© Atlantide Phototravel/Corbis



Detail
© Michele Burgess/Alamy

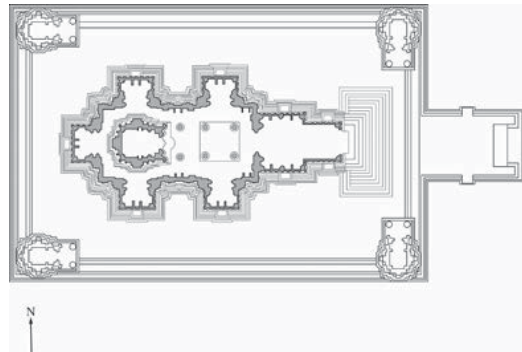

Lakshmana Temple plan

201. *Travelers among Mountains and Streams.* Fan Kuan. c. 1000 C.E. Ink and colors on silk.



Travelers among Mountains and Streams

© Fan Kuan/Corbis

202. Shiva as Lord of Dance (Nataraja). Hindu; India (Tamil Nadu), Chola Dynasty. c. 11th century C.E. Cast bronze.



Shiva as Nataraja

Image © The Metropolitan Museum of Art/Image Source © Art Resource, NY

203. *Night Attack on the Sanjō Palace.* Kamakura Period, Japan. c. 1250–1300 C.E. Handscroll (ink and color on paper). (2 images)



Night Attack on the Sanjō Palace

Photograph © 2013 Museum of Fine Arts, Boston



Detail

Photograph © 2013 Museum of Fine Arts, Boston

204. The David Vases. Yuan Dynasty, China. 1351 C.E. White porcelain with cobalt-blue underglaze.



The David Vases

© The Trustees of the British Museum/Art Resource, NY

205. Portrait of Sin Sukju (1417–1475). Imperial Bureau of Painting. c. 15th century C.E. Hanging scroll (ink and color on silk).



Portrait of Sin Sukju

Used by Permission

206. Forbidden City. Beijing, China. Ming Dynasty. 15th century C.E. and later. Stone masonry, marble, brick, wood, and ceramic tile. (5 images)



Forbidden City

© Atlantide Phototravel/Corbis



Front Gate

© John Lander Photography

Forbidden City, *continued*



Hall of Supreme Harmony
© Steven Vidler/Eurasia Press/Corbis



The Palace of Tranquility and Longevity
© As seen in Art and Antiques

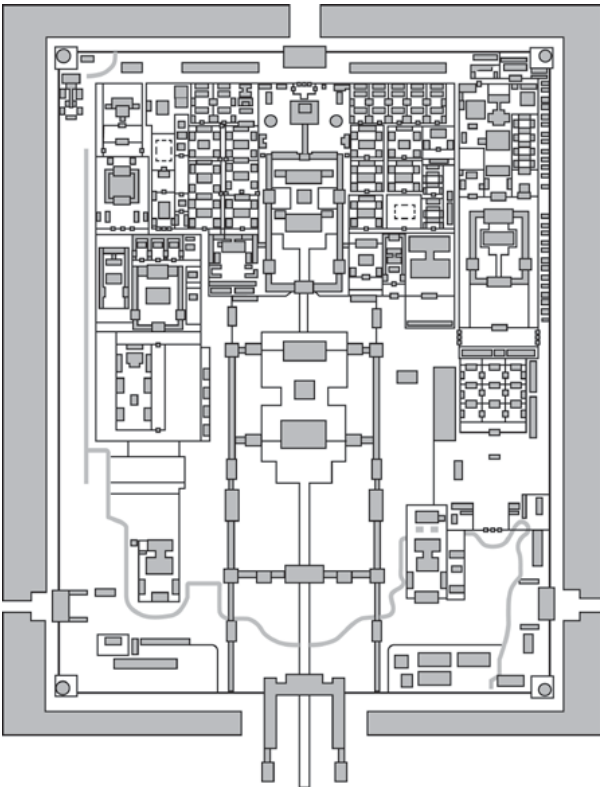

Forbidden City plan

207. **Ryoan-ji.** Kyoto, Japan. Muromachi Period, Japan. c. 1480 C.E.; current design most likely dates to the 18th century. Rock garden. (3 images)



Ryoan-ji, wet garden
© John Lander Photography



Ryoan-ji, dry garden
© Vanni Archive/Art Resource, NY

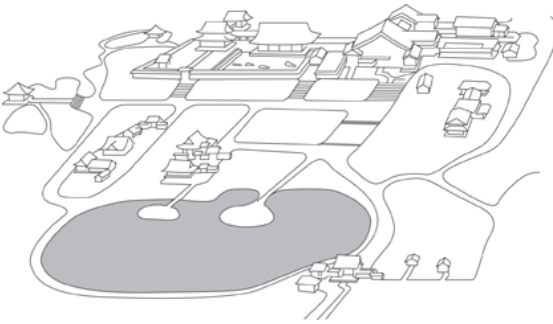

Ryoan-ji plan

208. **Jahangir Preferring a Sufi Shaikh to Kings**. Bichitr. c. 1620 C.E. Watercolor, gold, and ink on paper.

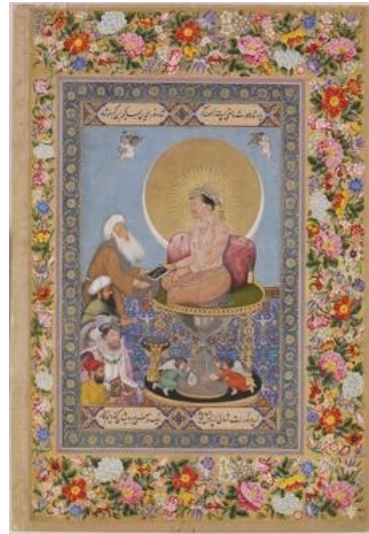

Jahangir Preferring a Sufi Shaikh to Kings
© Freer Gallery of Art, Smithsonian Institution, Washington, D.C.

209. Taj Mahal. Agra, Uttar Pradesh, India. Masons, marble workers, mosaicists, and decorators working under the supervision of Ustad Ahmad Lahori, architect of the emperor. 1632–1653 C.E. Stone masonry and marble with inlay of precious and semiprecious stones; gardens. (2 images)



Taj Mahal
© David Pearson/Alamy



Taj Mahal
© Ocean/Corbis

210. White and Red Plum Blossoms. Ogata Korin. c. 1710–1716 C.E. Ink, watercolor, and gold leaf on paper. (2 images)



White and Red Plum Blossoms
© MOA Museum of Art



White and Red Plum Blossoms
© MOA Museum of Art

211. ***Under the Wave off Kanagawa (Kanagawa okinamiura)***, also known as the Great Wave, from the series **Thirty-six Views of Mount Fuji**. *Katsushika* Hokusai. 1830–1833 C.E. Polychrome woodblock print; ink and color on paper.



Kanagawa oki nami ura

Image © The Metropolitan Museum of Art/Image Source © Art Resource, NY

212. ***Chairman Mao en Route to Anyuan***. Artist unknown; based on an oil painting by Liu Chunhua. c. 1969 C.E. Color lithograph.

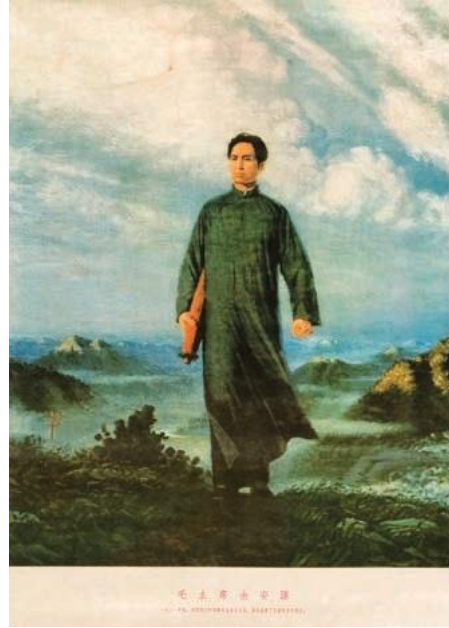

Chairman Mao en Route to Anyuan

© The Chambers Gallery, London/The Bridgeman Art Library

213. Nan Madol. Pohnpei, Micronesia. Saudeleur Dynasty. c. 700–1600 C.E. Basalt boulders and prismatic columns. (2 images)



Nan Madol
© Jack Fields/Corbis



Nan Madol
© Jack Fields/Corbis

214. Moai on platform (ahu). Rapa Nui (Easter Island). c. 1100–1600 C.E. Volcanic tuff figures on basalt base.



Moai
© Peter Langer/Design Pics/Corbis

215. 'Ahu 'ula (feather cape). Hawaiian. Late 18th century C.E. Feathers and fiber.



'Ahu 'ula
© The Trustees of the British Museum/Art Resource, NY

216. Staff god. Rarotonga, Cook Islands, central Polynesia. Late 18th to early 19th century C.E. Wood, tapa, fiber, and feathers. (3 images)



Staff god

© The Trustees of the British Museum



Detail

© The Trustees of the British Museum

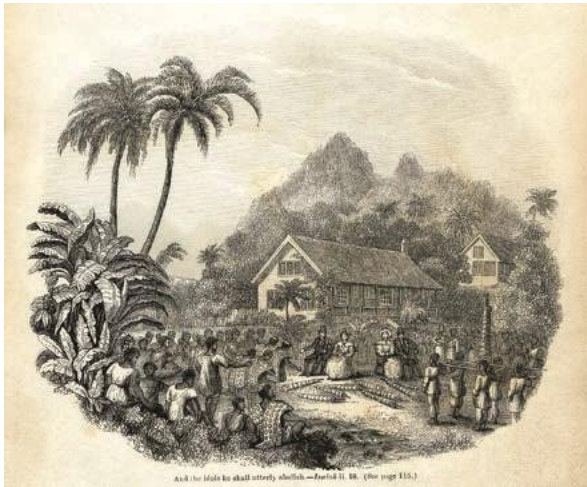

Contextual image: staff god

© The Trustees of the British Museum

217. Female deity. Nukuoro, Micronesia. c. 18th to 19th century C.E. Wood.



Female deity

© Werner Forman Archive/The Bridgeman Art Library

218. Buk (mask). Torres Strait. Mid- to late 19th century C.E. Turtle shell, wood, fiber, feathers, and shell.



Buk

Image © The Metropolitan Museum of Art/Image source © Art Resource, NY

219. Hiapo (tapa). Niue. c. 1850–1900 C.E. Tapa or bark cloth, freehand painting.



Hiapo

© Auckland War Memorial Museum/Pacific Collection 1948.34

220. *Tamati Waka Nene*. Gottfried Lindauer. 1890 C.E. Oil on canvas.



Tamati Waka Nene

© Corbis

221. Navigation chart. Marshall Islands, Micronesia. 19th to early 20th century C.E. Wood and fiber.

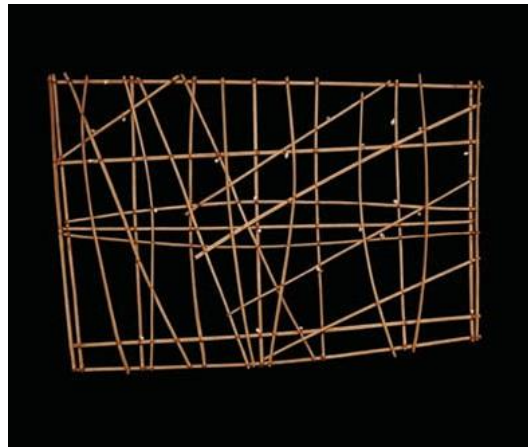

Navigation chart

© The Trustees of the British Museum

222. Malagan display and mask. New Ireland Province, Papua New Guinea. c. 20th century C.E. Wood, pigment, fiber, and shell. (2 images)



Malagan mask

University Museum, Pennsylvania, PA, USA/Photo © AISA/The Bridgeman Art Library



Malagan display

© Peter Homer, 1978 © Museum der Kulturen Basel, Switzerland

223. Presentation of Fijian mats and tapa cloths to Queen Elizabeth II. Fiji, Polynesia. 1953 C.E. Multimedia performance (costume; cosmetics, including scent; chant; movement; and *pandanus* fiber/hibiscus fiber mats), photographic documentation.



Presentation of Fijian mats and tapa cloths to Queen Elizabeth II during the 1953-4 royal tour

Courtesy of Alexander Turnbull Library, Wellington, New Zealand

224. *The Gates*. New York City, U.S. Christo and Jeanne-Claude. 1979–2005 C.E.
Mixed-media installation. (2 images)



The Gates

© Panoramic Images/Getty Images

The Gates

© Chip East/Reuters/Corbis

225. Vietnam Veterans Memorial. Washington, D.C., U.S. Maya Lin. 1982 C.E. Granite.
(2 images)



Vietnam Veterans Memorial

© James P. Blair/Corbis



Detail

© Ian Dagnall/Alamy

226. *Horn Players*. Jean-Michel Basquiat. 1983 C.E. Acrylic and oil paintstick on three canvas panels.



Horn Players

Photography © Douglas M. Parker Studio, Los Angeles
© The Estate of the Artist/ADAGP, Paris/ARS New York 2013

227. *Summer Trees*. Song Su-nam. 1983 C.E. Ink on paper.

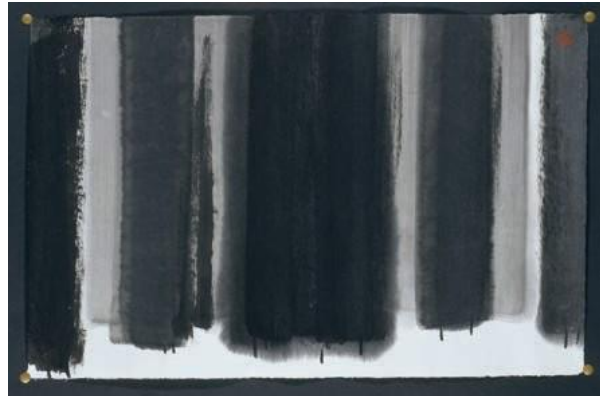

Summer Trees

© The Trustees of the British Museum

228. *Androgyne III*. Magdalena Abakanowicz. 1985 C.E. Burlap, resin, wood, nails, and string.



Androgyne III

© Magdalena Abakanowicz, Courtesy Marlborough Gallery, New York/Image © The Metropolitan Museum of Art/Image Source © Art Resource, NY

229. *A Book from the Sky*. Xu Bing. 1987–1991 C.E. Mixed-media installation.



A Book from the Sky

Used by Permission

230. ***Pink Panther***. Jeff Koons. 1988 C.E.
Glazed porcelain.



Pink Panther

Permission of the Artist © The Museum of Modern Art/Licensed
by SCALA/Art Resource, NY

231. ***Untitled* (#228)**, from the ***History Portraits*** series. Cindy Sherman.
1990 C.E. Photograph.



Untitled (#228)

Courtesy of the Artist and Metro Pictures

232. ***Dancing at the Louvre***, from the series ***The French Collection, Part I; #1***.
Faith Ringgold. 1991 C.E. Acrylic on canvas, tie-dyed, pieced fabric border.



Dancing at the Louvre, from the series
The French Collection, Part I; #1

Faith Ringgold © 1991

233. ***Trade (Gifts for Trading Land with White People)***. Jaune Quick-to-See Smith.
1992 C.E. Oil and mixed media on canvas.



Trade (Gifts for Trading Land with White People)

Courtesy of Jaune Quick-to-See Smith (Member of the Salish Kootenai Nation,
Montana) and the Accola Griefen Gallery, NY

234. *Earth's Creation*. Emily Kame Kngwarreye. 1994 C.E. Synthetic polymer paint on canvas.



Earth's Creation

© VISCOPY, Australia/Image © National Museum of Australia/© 2013 Artists Rights Society (ARS), New York

235. *Rebellious Silence*, from the *Women of Allah* series. Shirin Neshat (artist); photo by Cynthia Preston. 1994 C.E. Ink on photograph.



Rebellious Silence

Courtesy Gladstone Gallery, New York and Brussels

236. *En la Barberia no se Llora (No Crying Allowed in the Barbershop)*. Pepon Osorio. 1994 C.E. Mixed-media installation.



En la Barberia no se Llora

Courtesy Ronald Feldman Fine Arts, New York/
www.feldmangallery.com

237. *Pisupo Lua Afe (Corned Beef 2000)*. Michel Tuffery. 1994 C.E. Mixed media.



Pisupo Lua Afe

© Michel Tuffery MNZM/Museum of New Zealand Te Papa Tongarewa # FE010516

238. *Electronic Superhighway*. Nam June Paik. 1995 C.E. Mixed-media installation (49-channel closed-circuit video installation, neon, steel, and electronic components).



Electronic Superhighway

Photo © Smithsonian American Art Museum, Washington, DC/Art Resource, NY

239. *The Crossing*. Bill Viola. 1996 C.E. Video/sound installation.

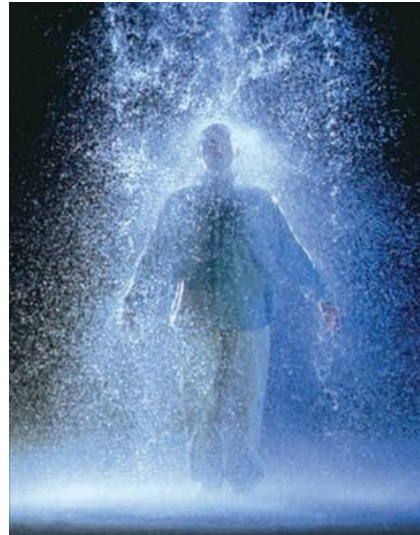

The Crossing

Photo © Kira Perov

240. *Guggenheim Museum Bilbao*. Spain. Frank Gehry (architect). 1997 C.E. Titanium, glass, and limestone. (3 images)



Guggenheim Museum Bilbao

© Rolf Haid/dpa/Corbis



Guggenheim Museum Bilbao

© Jacques Pavlovsky/Syigma/CORBIS

Guggenheim Museum Bilbao, continued

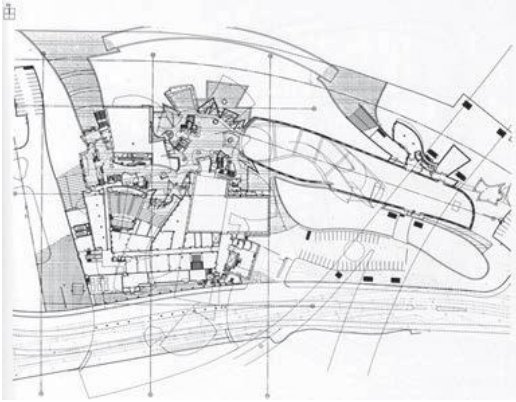

Guggenheim Museum Bilbao site plan

© FMGB Guggenheim Bilbao Museoa

241. *Pure Land*. Mariko Mori. 1998 C.E.
Color photograph on glass.



Pure Land

© 2013 Mariko Mori, Member Artists Rights Society (ARS), New York/Digital Image © 2013 Museum Associates/LACMA/Licensed by Art Resource, NY

242. *Lying with the Wolf*. Kiki Smith. 2001 C.E.
Ink and pencil on paper.



Lying with the Wolf

© The Artist/Courtesy of the Pace Gallery

243. *Darkytown Rebellion*. Kara Walker. 2001 C.E.
Cut paper and projection on wall.



Darkytown Rebellion

Used by Permission

244. *The Swing (after Fragonard).* Yinka Shonibare. 2001 C.E. Mixed-media installation.



The Swing (after Fragonard)

© 2013 Tate, London

245. *Old Man's Cloth.* El Anatsui. 2003 C.E. Aluminum and copper wire.



Old Man's Cloth

© Samuel P. Harn Museum of Art, University of Florida, Gainesville/Museum purchase with funds from friends of the Harn Museum

246. *Stadia II.* Julie Mehretu. 2004 C.E. Ink and acrylic on canvas.



Stadia II

© Julie Mehretu, American, b. 1970, *Stadia II*, 2004, Carnegie Museum of Art, Pittsburgh/Photograph © 2013 Carnegie Museum of Art, Pittsburgh

247. *Preying Mantra.* Wangechi Mutu. 2006 C.E. Mixed media on Mylar.

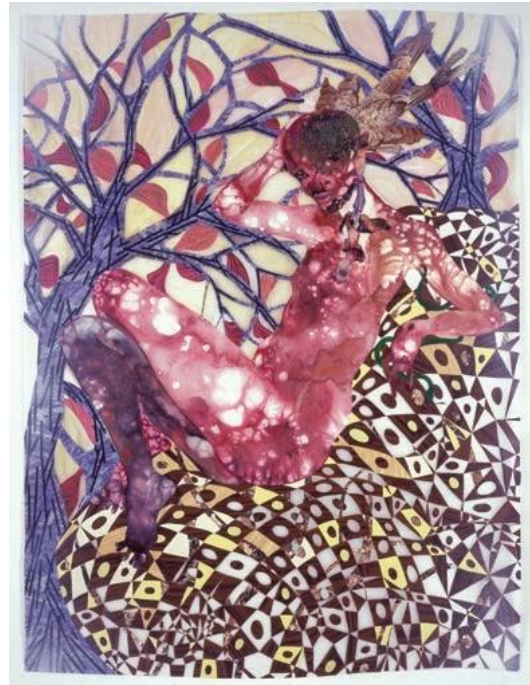

Preying Mantra

© Gladstone Gallery, New York and Brussels

248. *Shibboleth*. Doris Salcedo.
2007–2008 C.E. Installation.



Shibboleth

© Luke Macgregor/Reuters/Corbis

249. MAXXI National Museum of XXI Century Arts. Rome, Italy. Zaha Hadid (architect).
2009 C.E. Glass, steel, and cement. (2 images)



MAXXI National Museum of XXI
Century Arts

© Atlantide Photoravel/Corbis



MAXXI National Museum of XXI
Century Arts

© Alessandro Di Meo/epa/Corbis

250. ***Kui Hua Zi (Sunflower Seeds)***. Ai Weiwei. 2010–2011 C.E.
Sculpted and painted porcelain.



Kui Hua Zi

© Oliver Strowe/Getty Images